

**This electronic collection of documents is provided  
for the convenience of the user  
and is Not a Certified Document –**

**The documents contained herein were originally issued  
and sealed by the individuals whose names and license  
numbers appear on each page, on the dates appearing  
with their signature on that page.**

**This file or an individual page  
shall not be considered a certified document.**

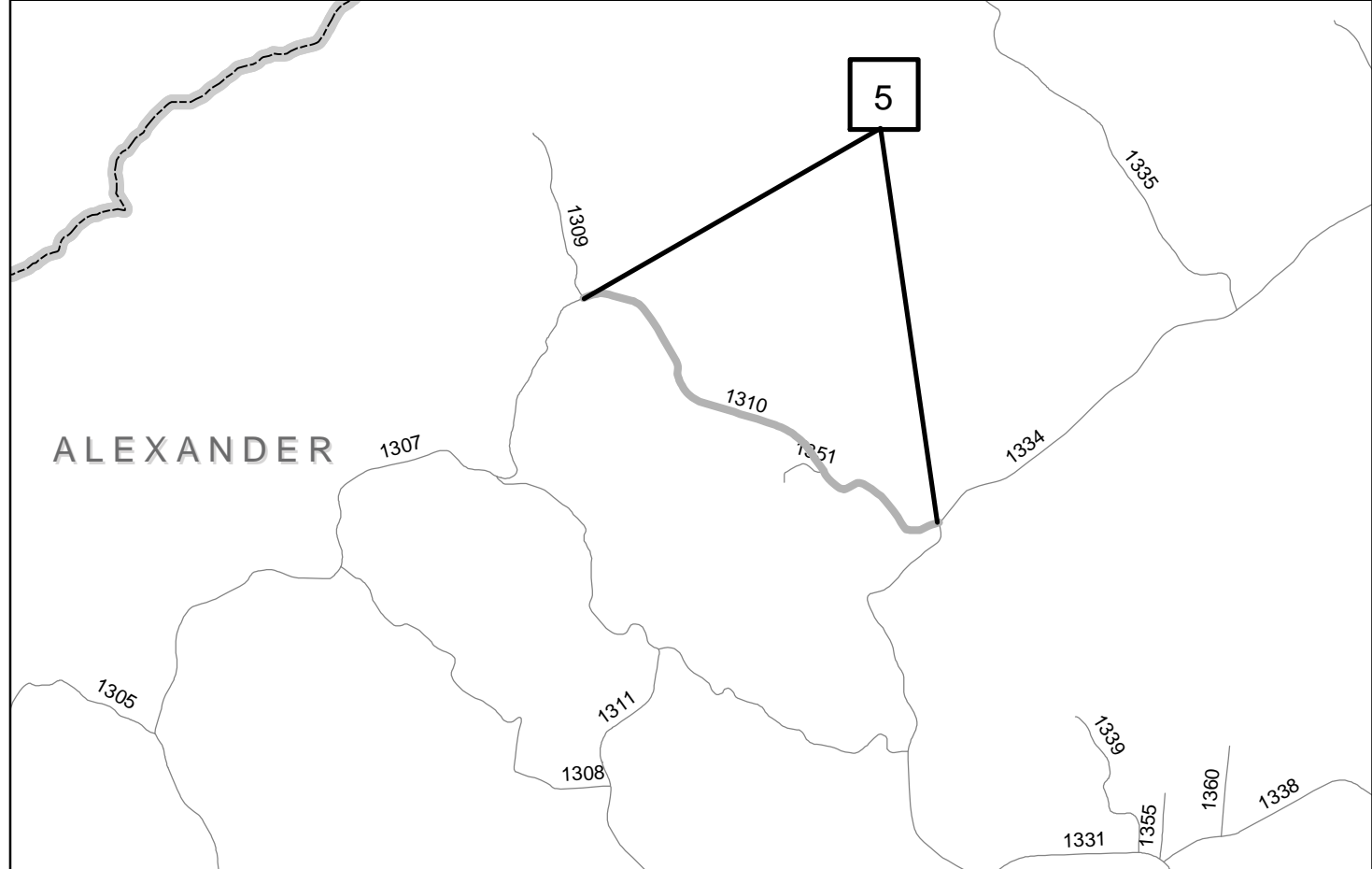

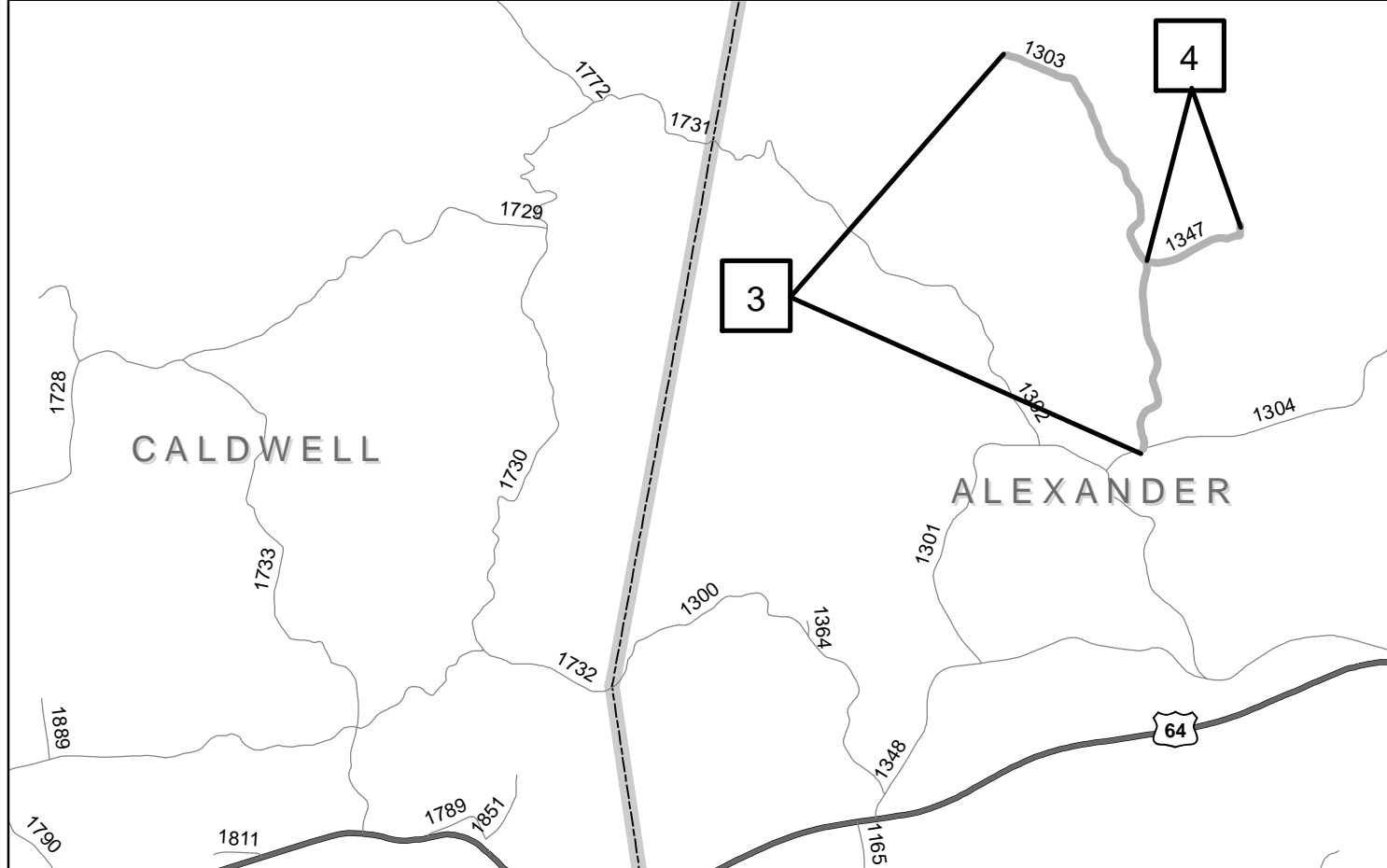
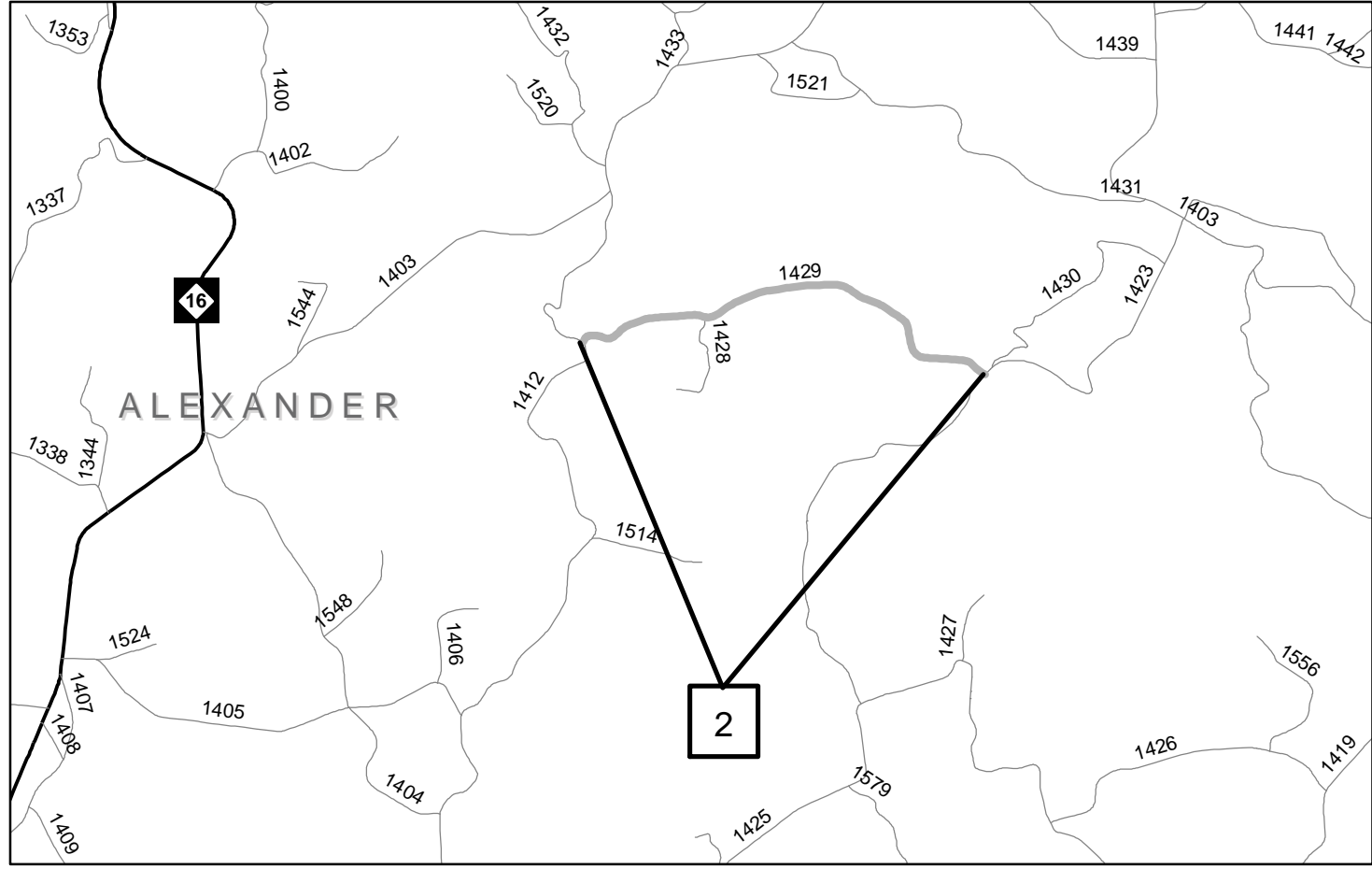
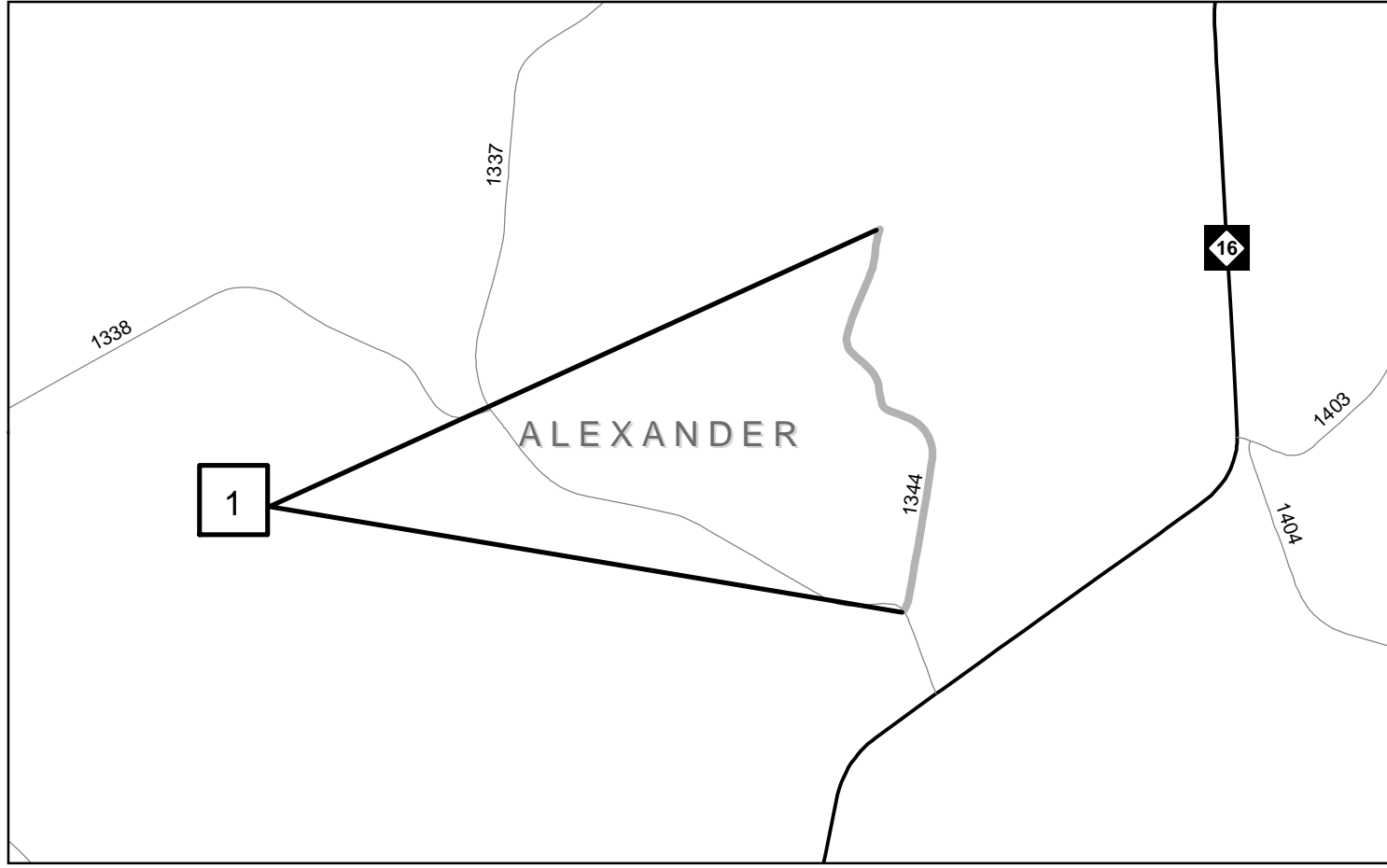
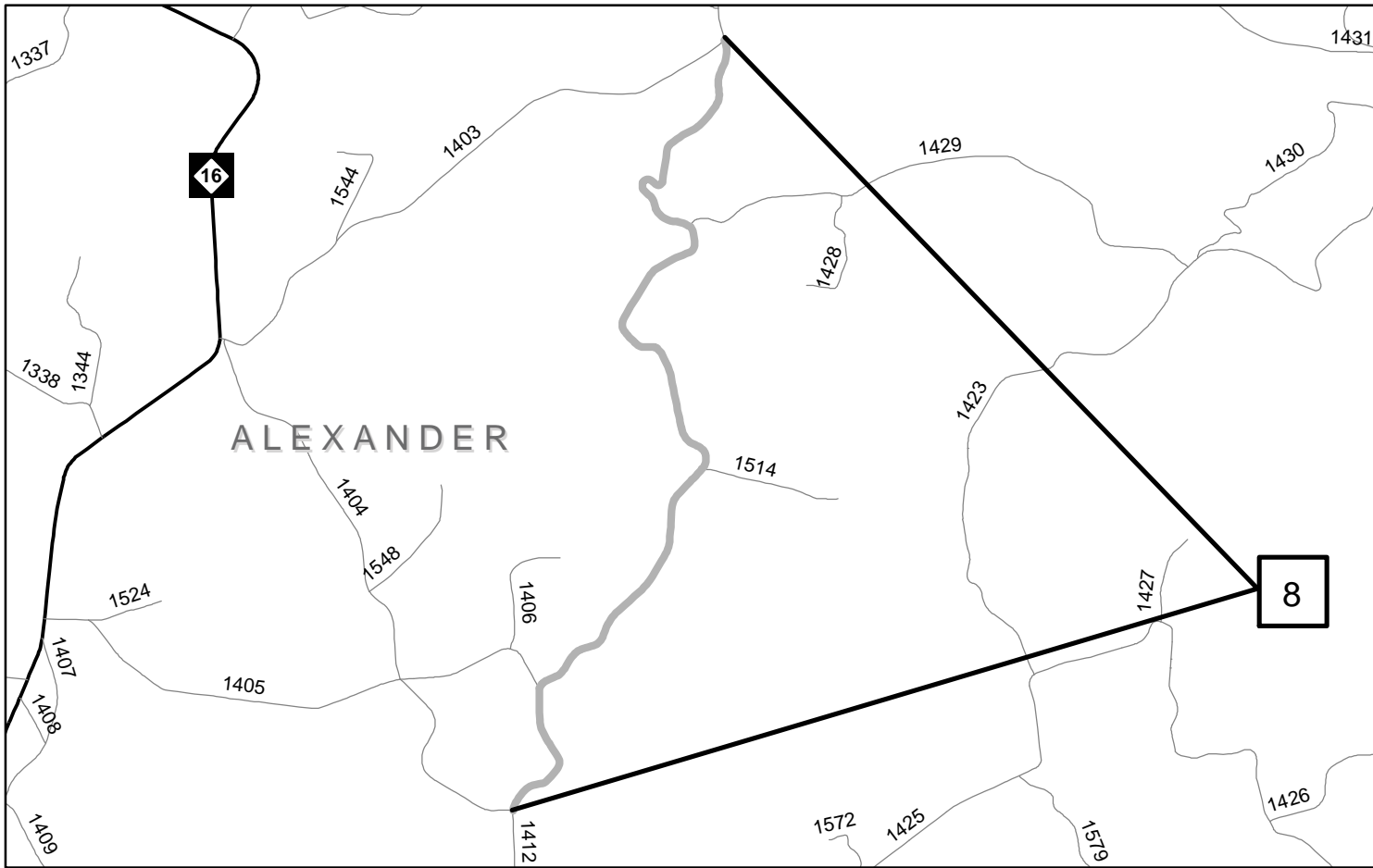
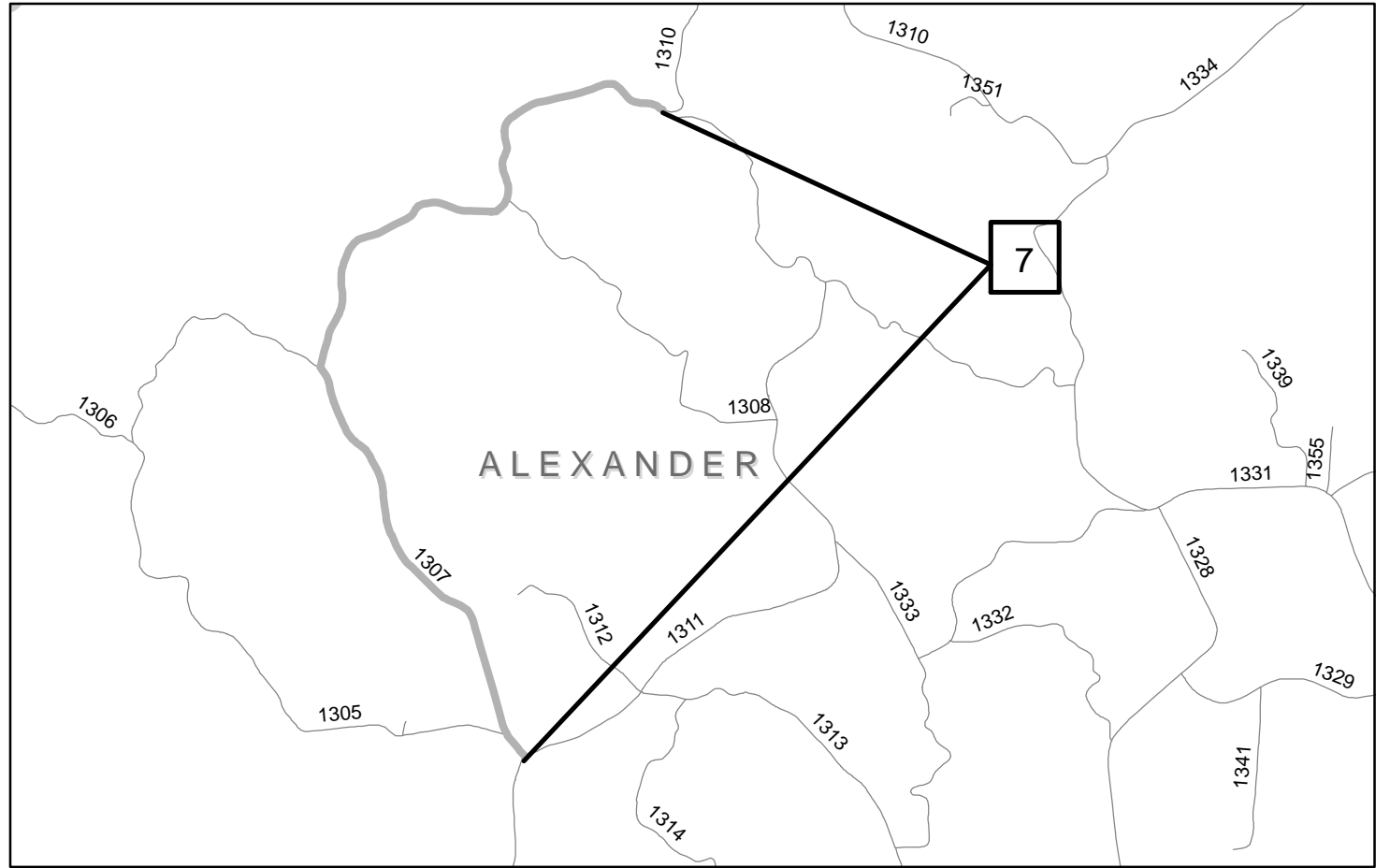
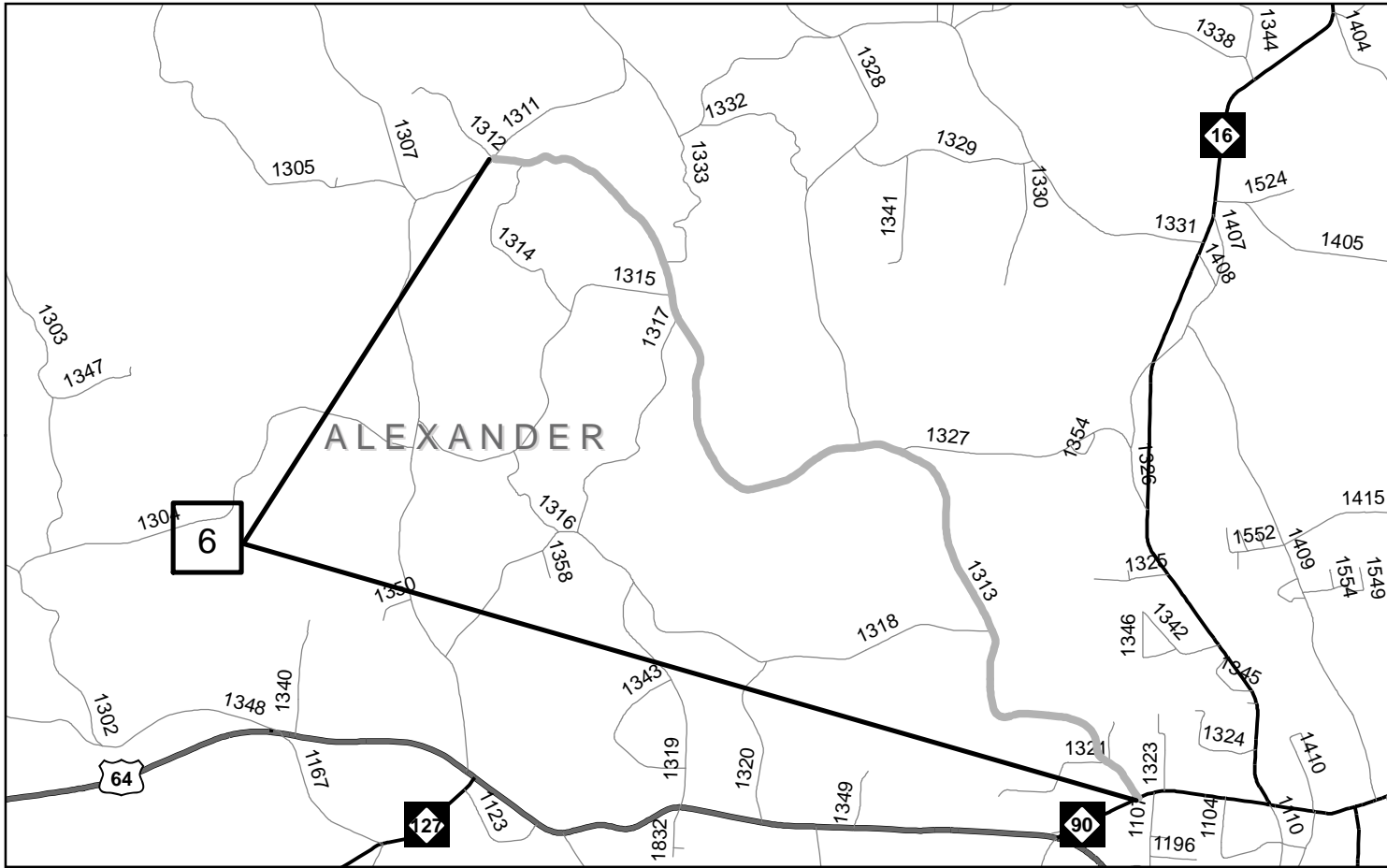

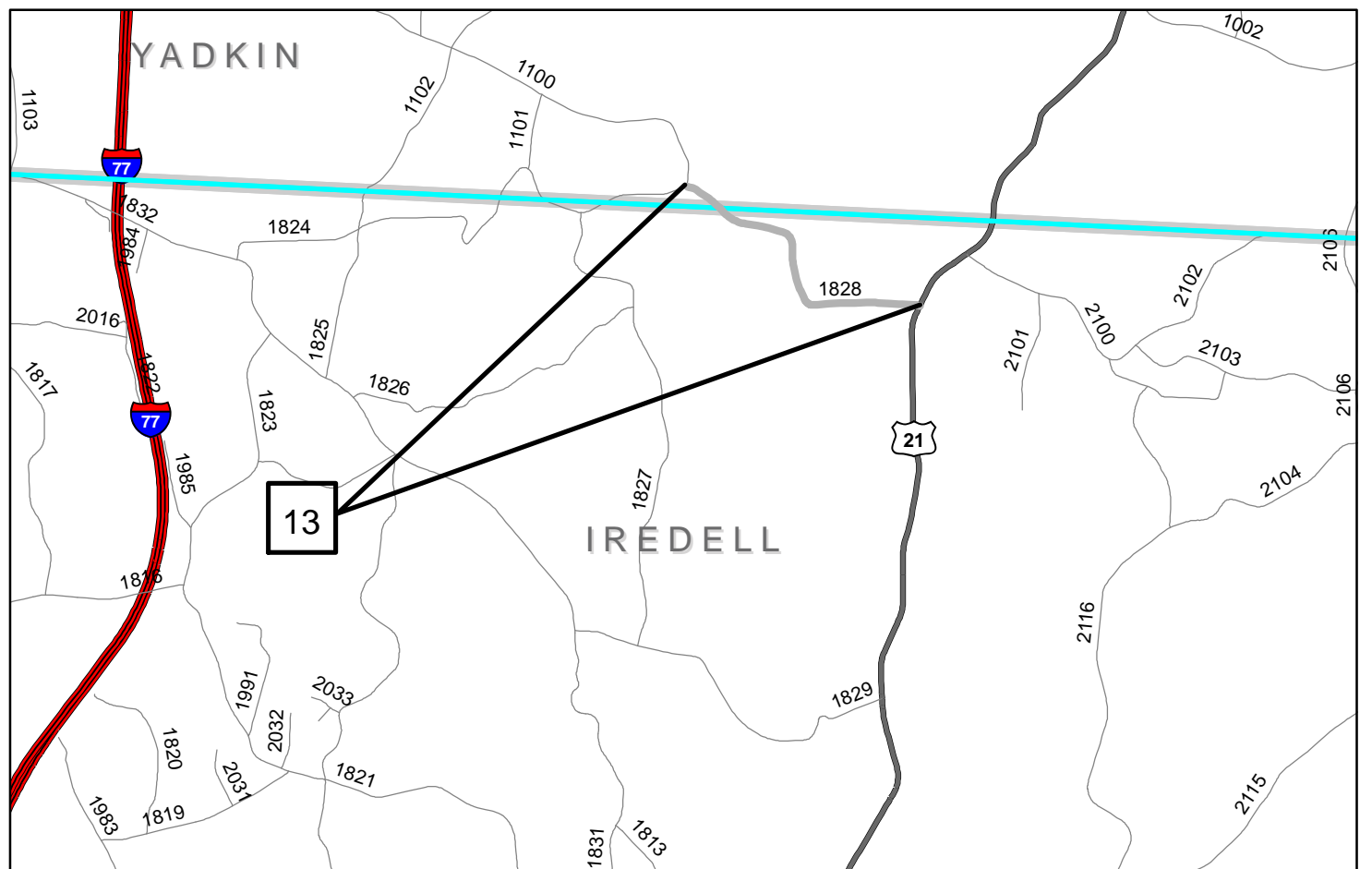
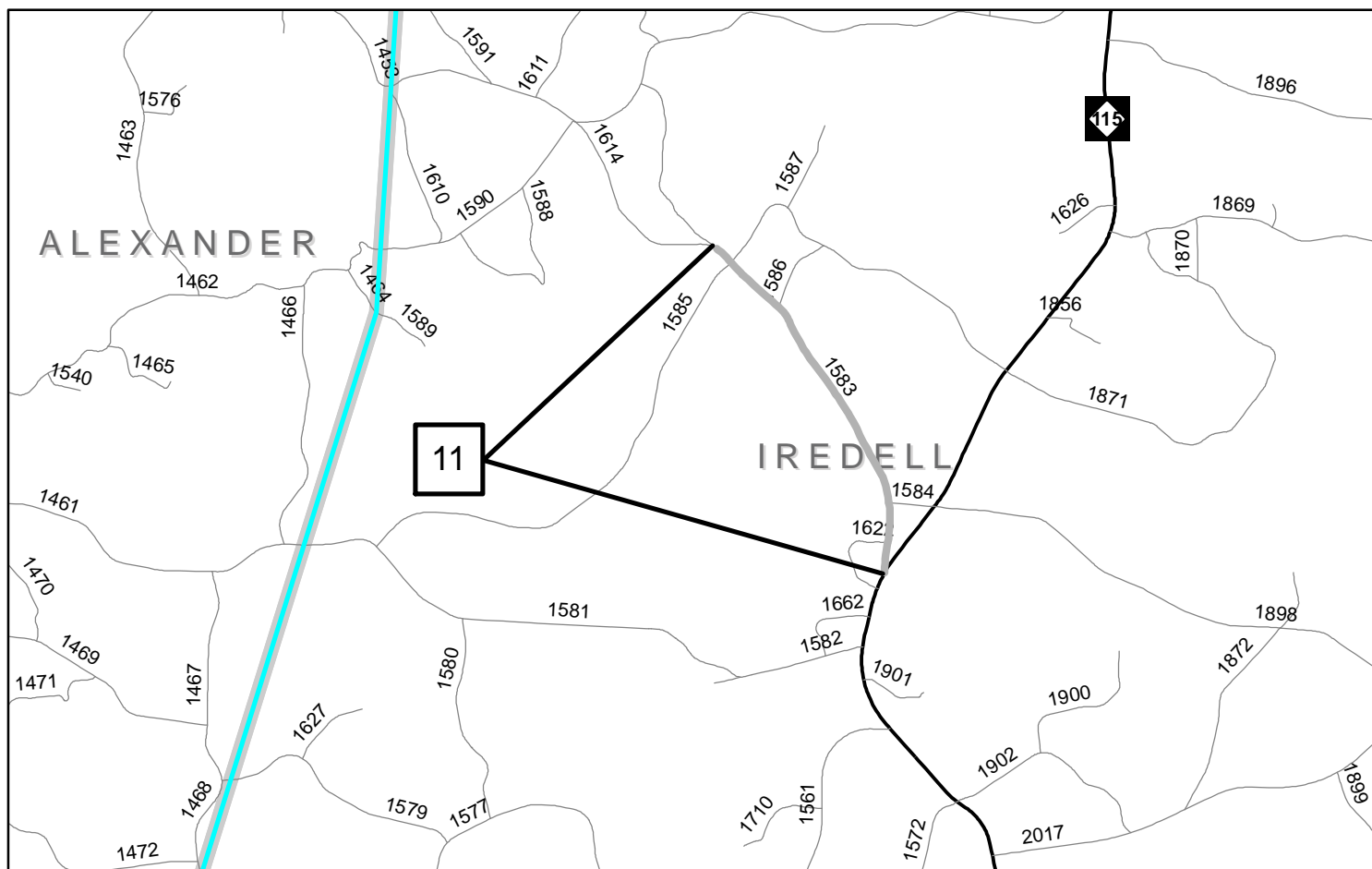
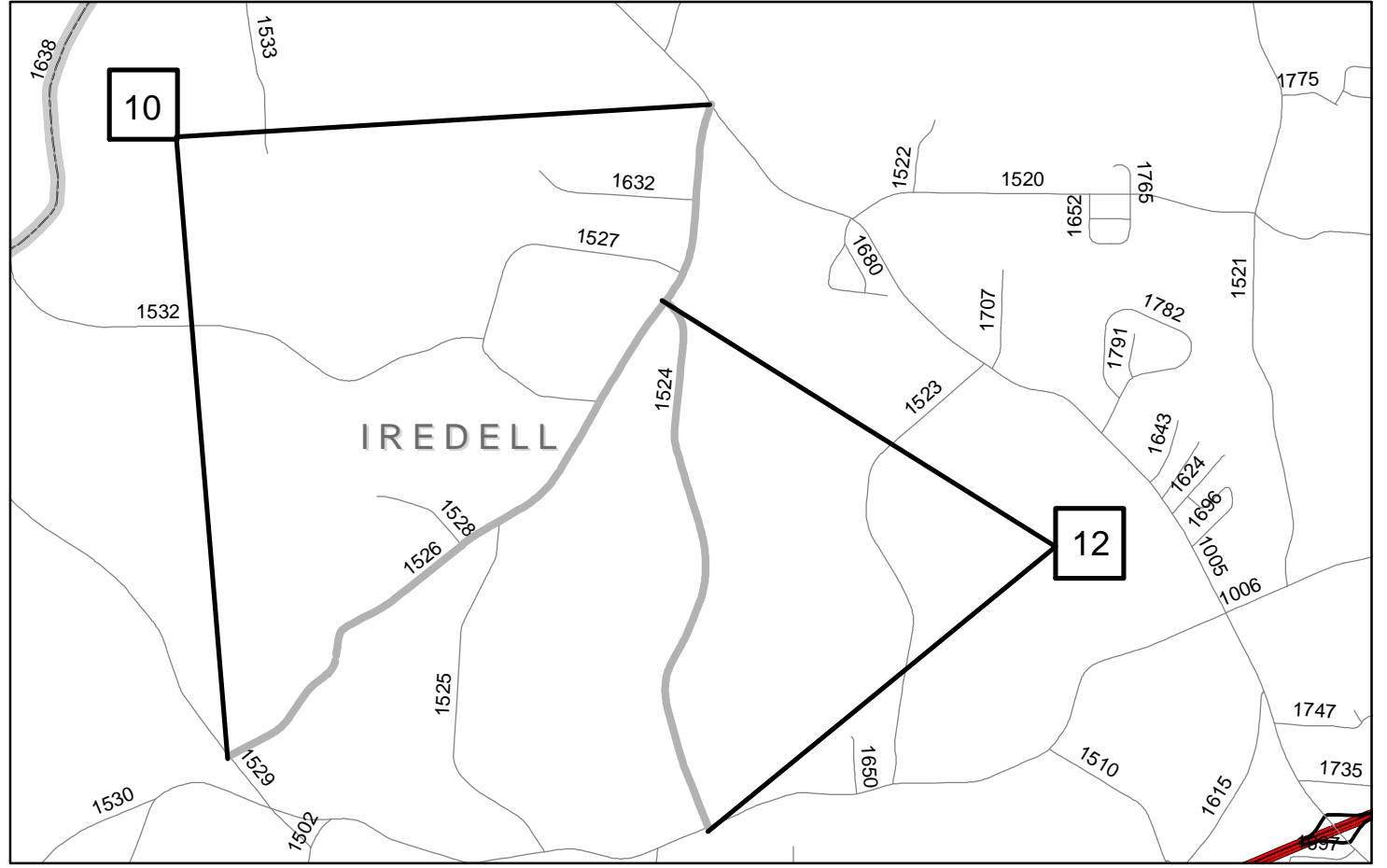
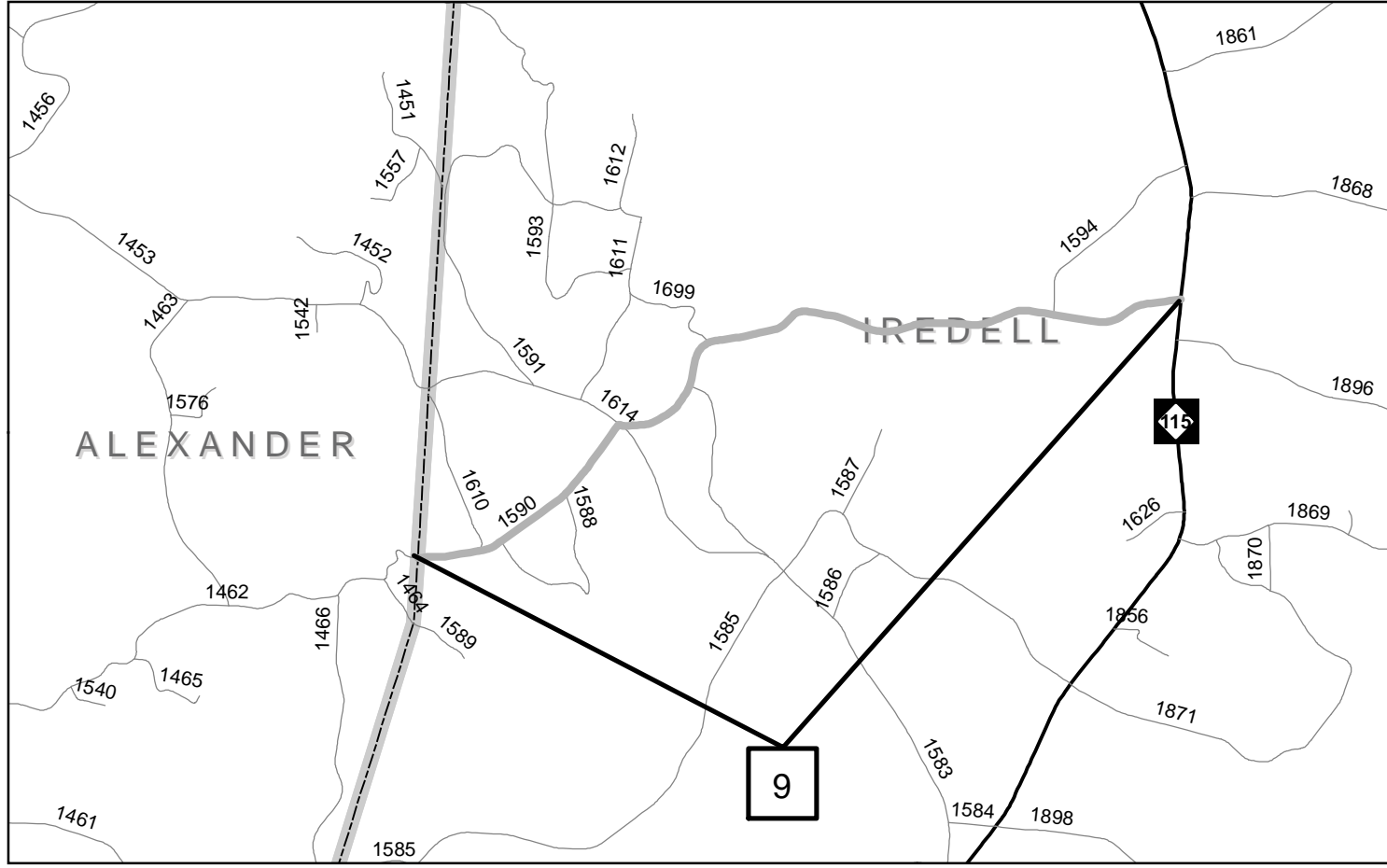

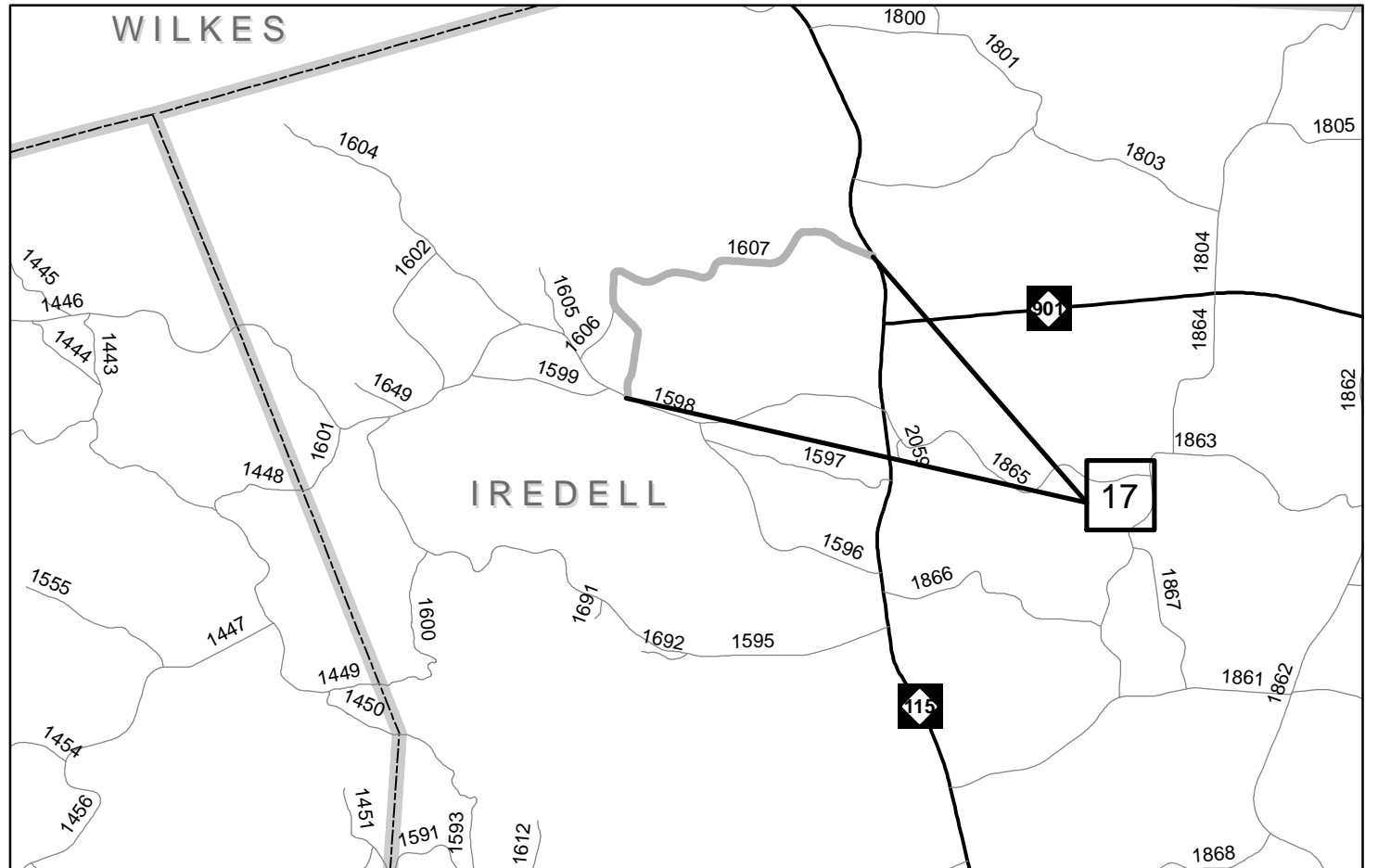
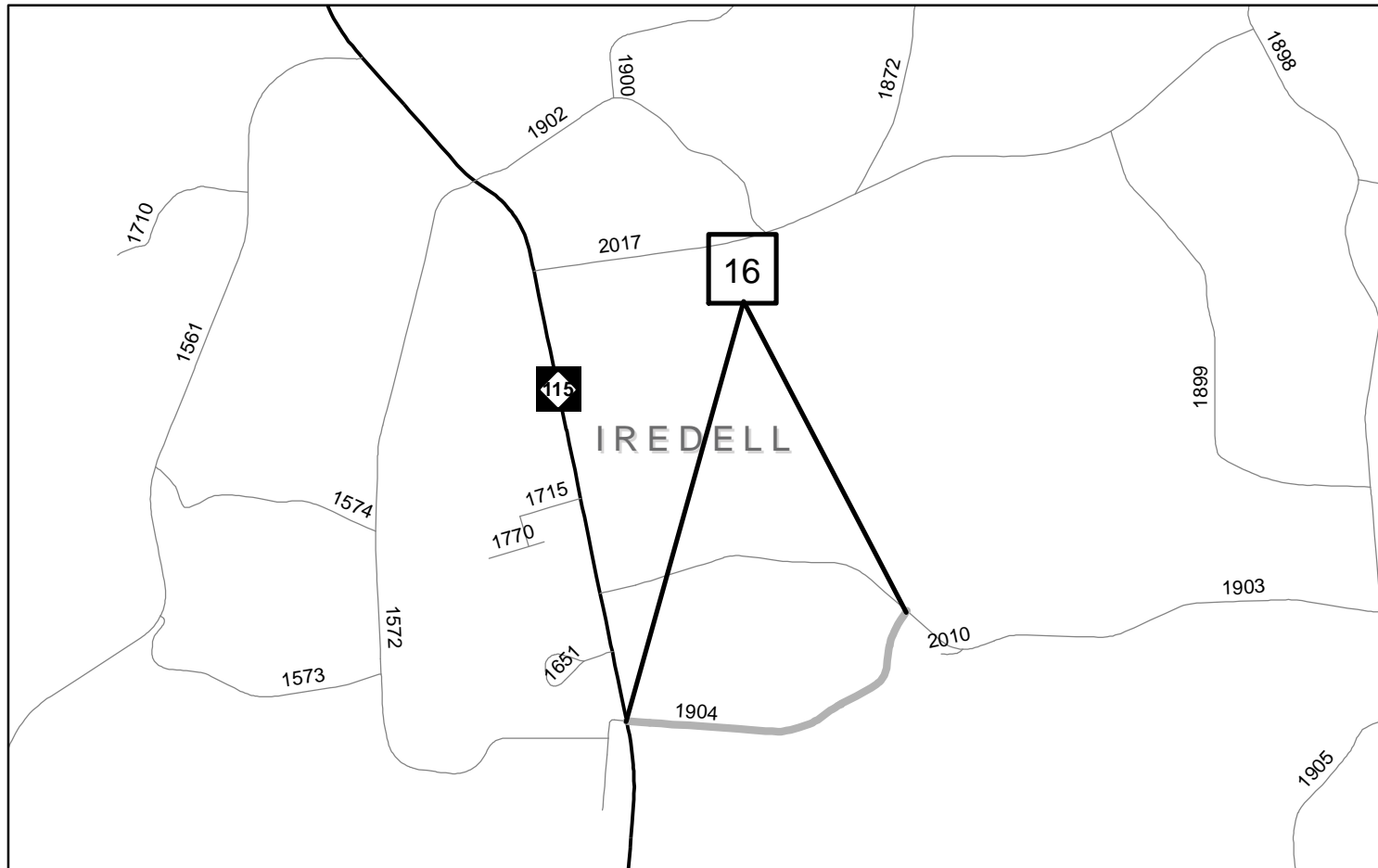
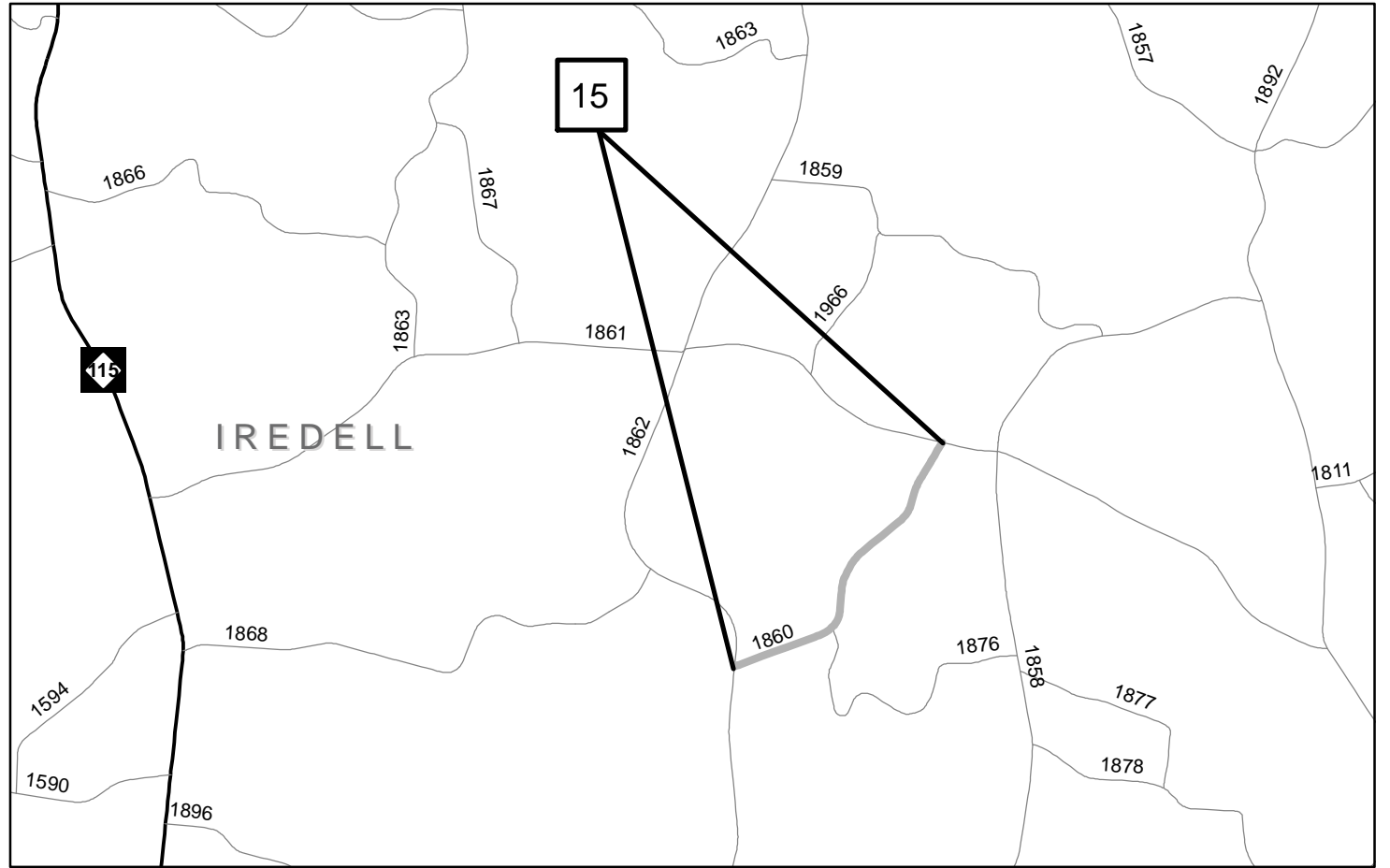
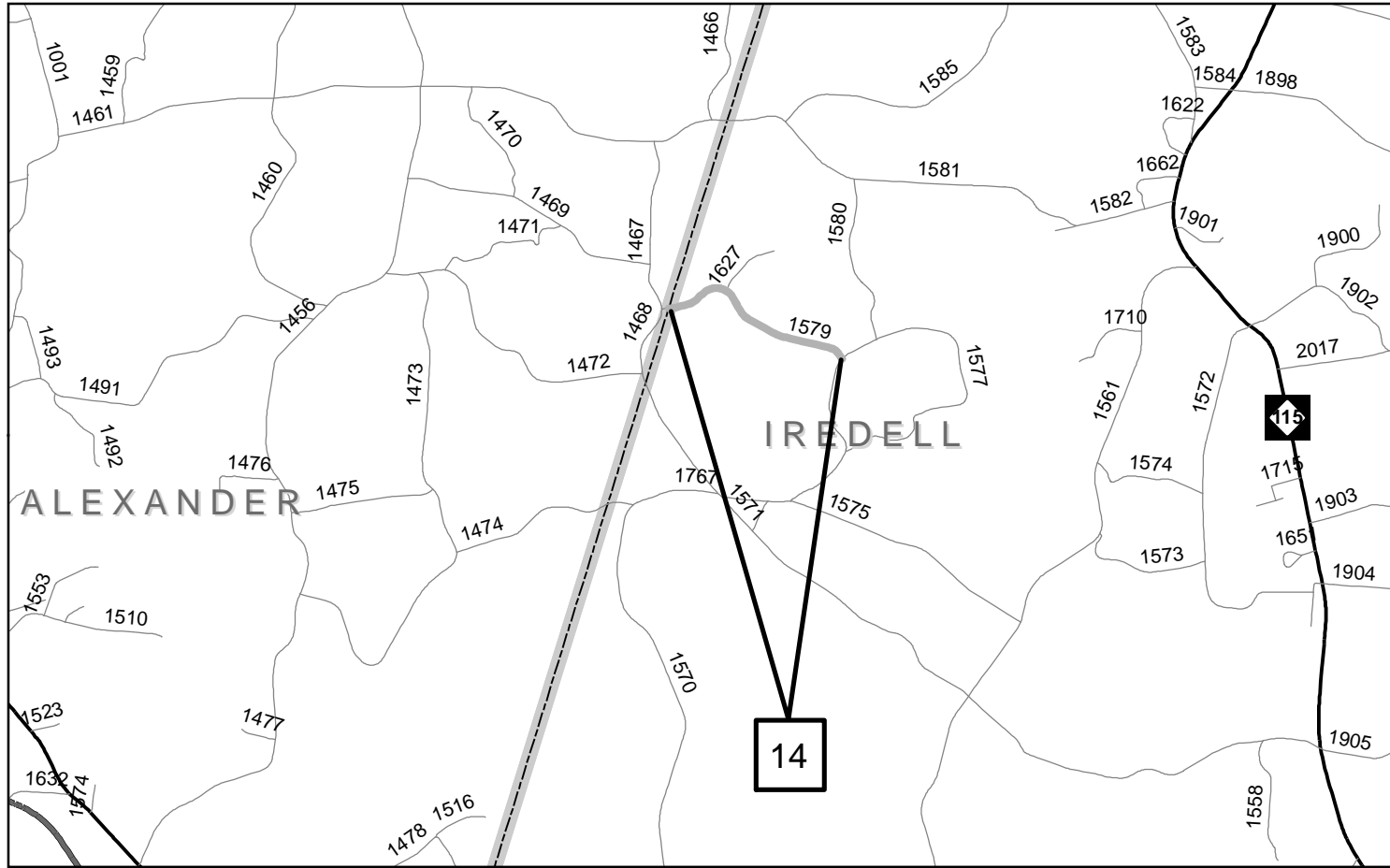

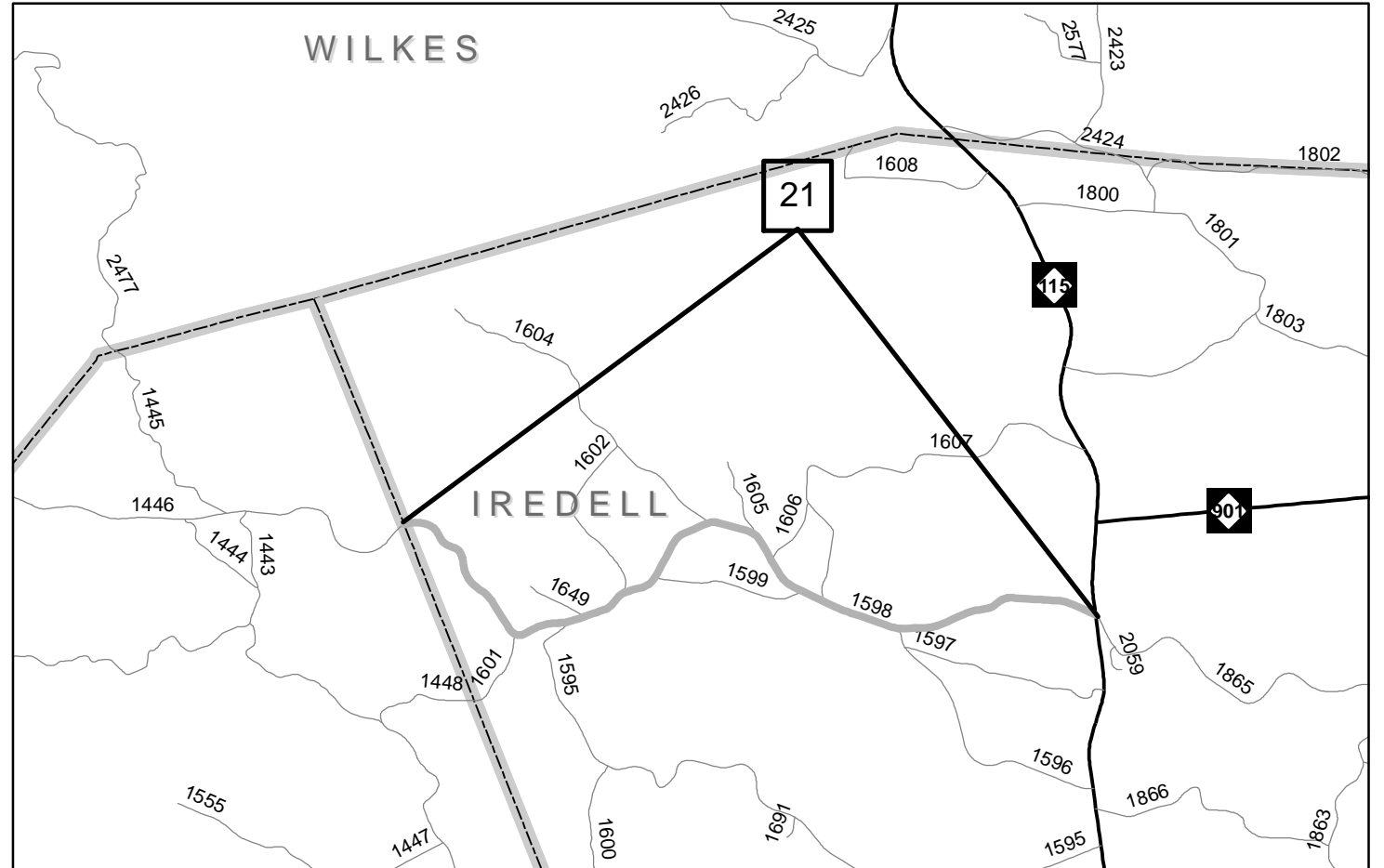
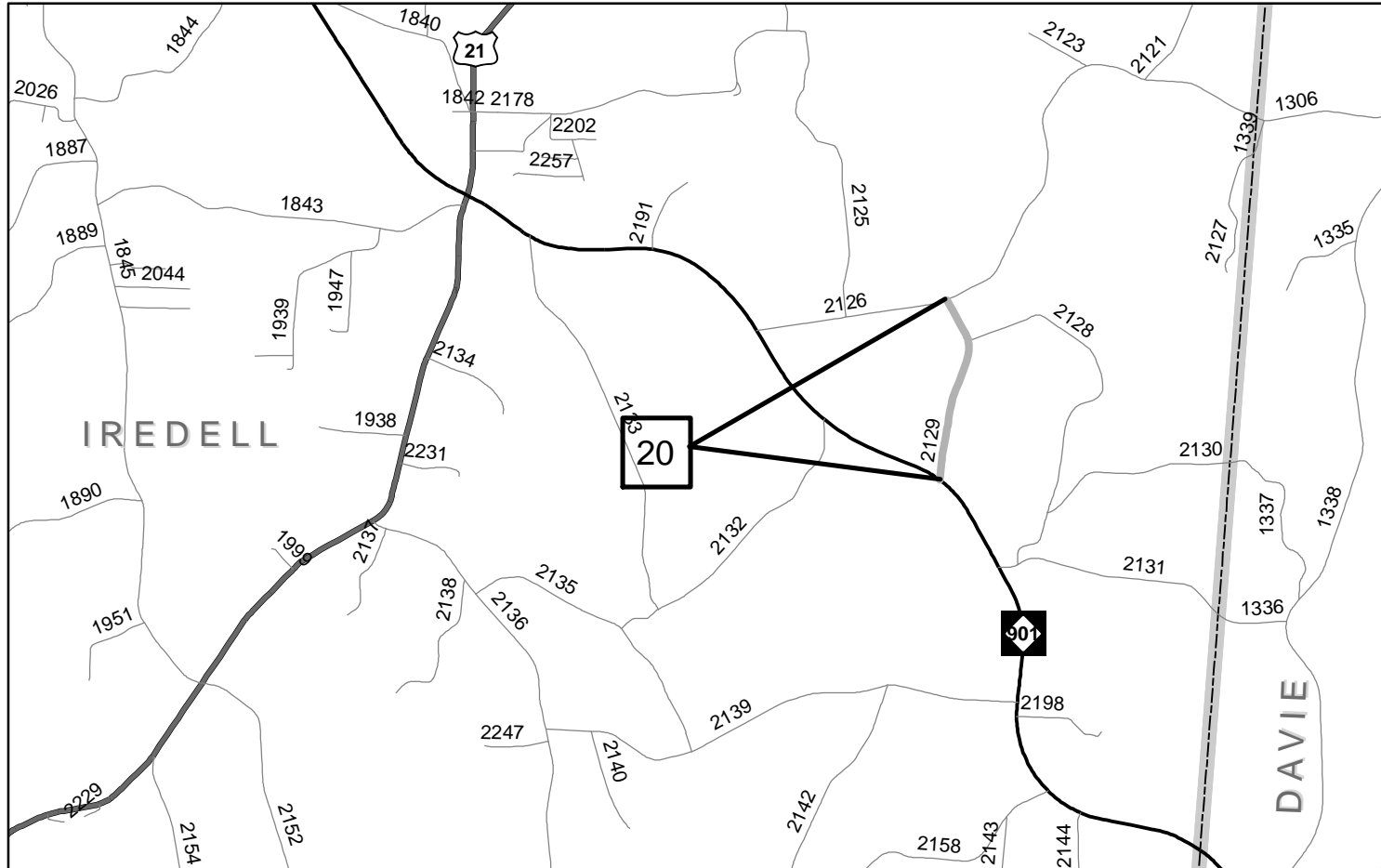
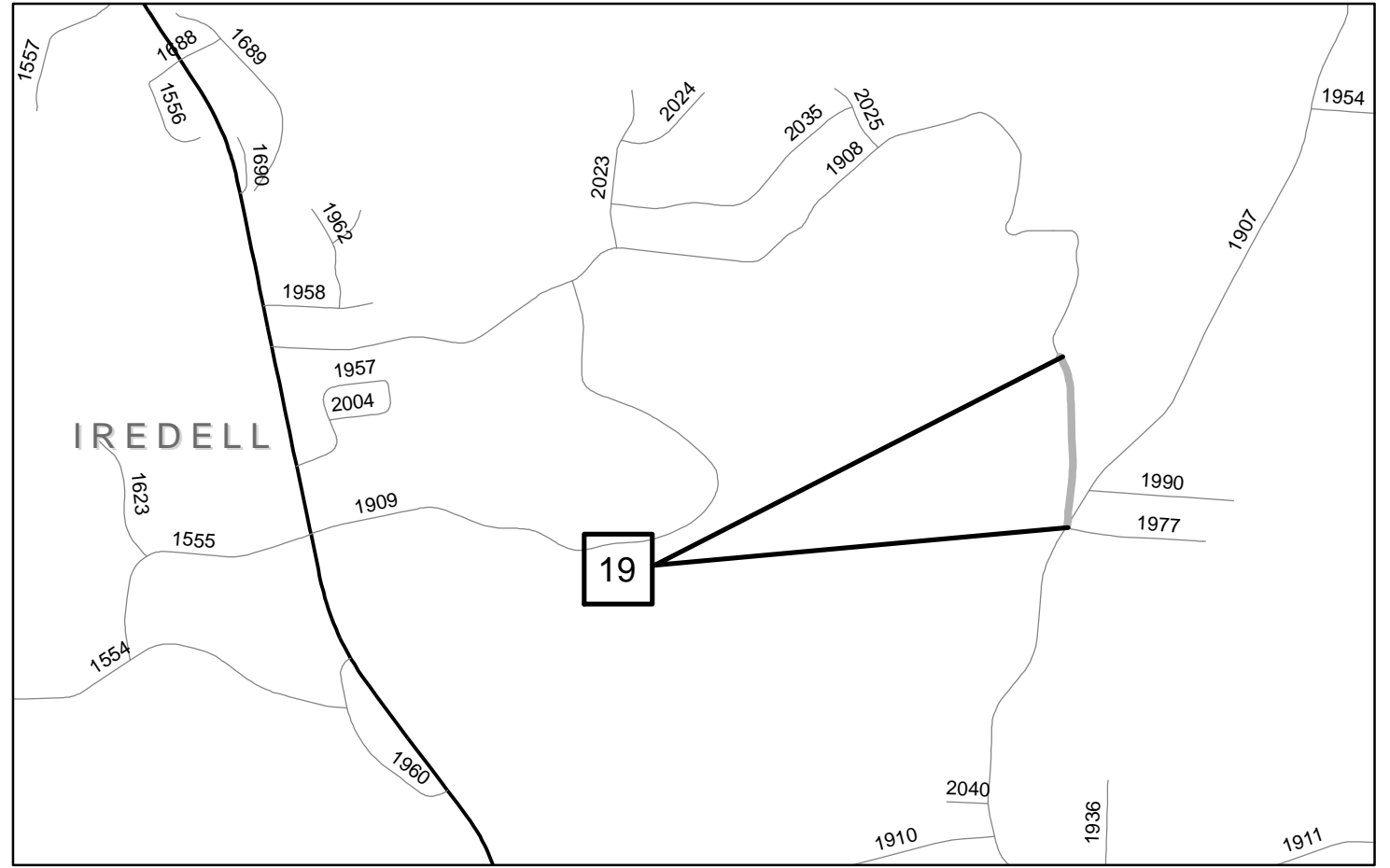
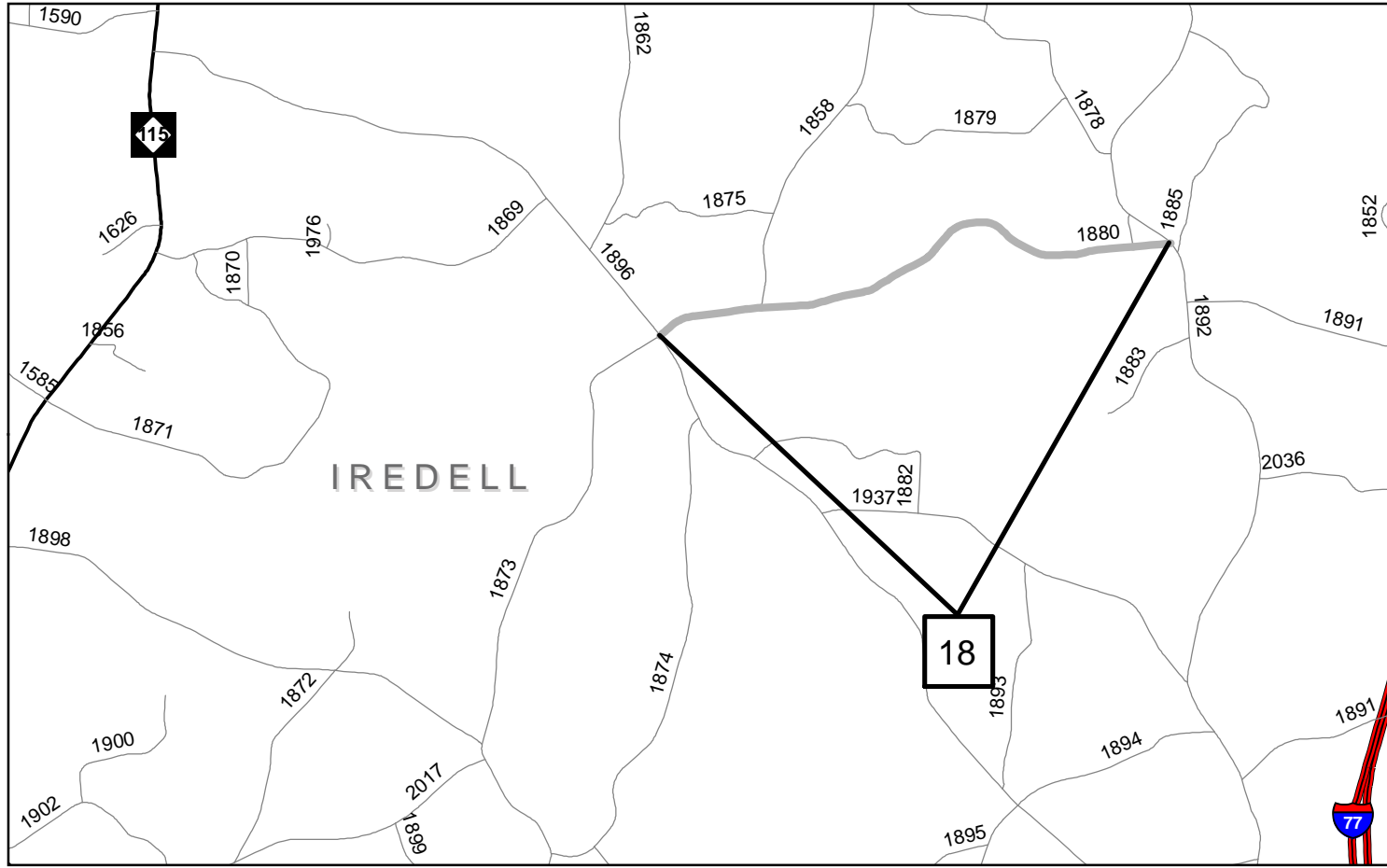

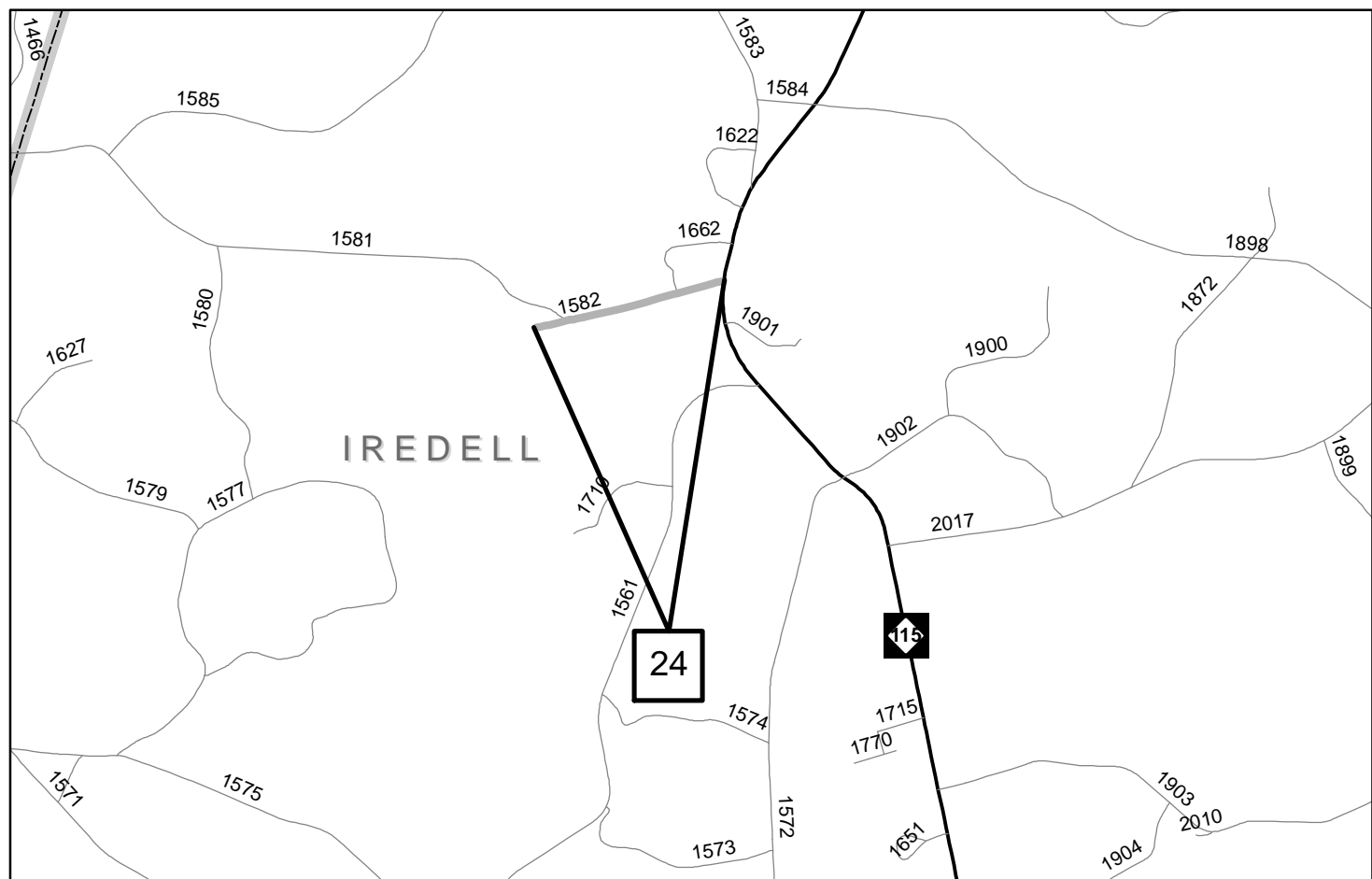
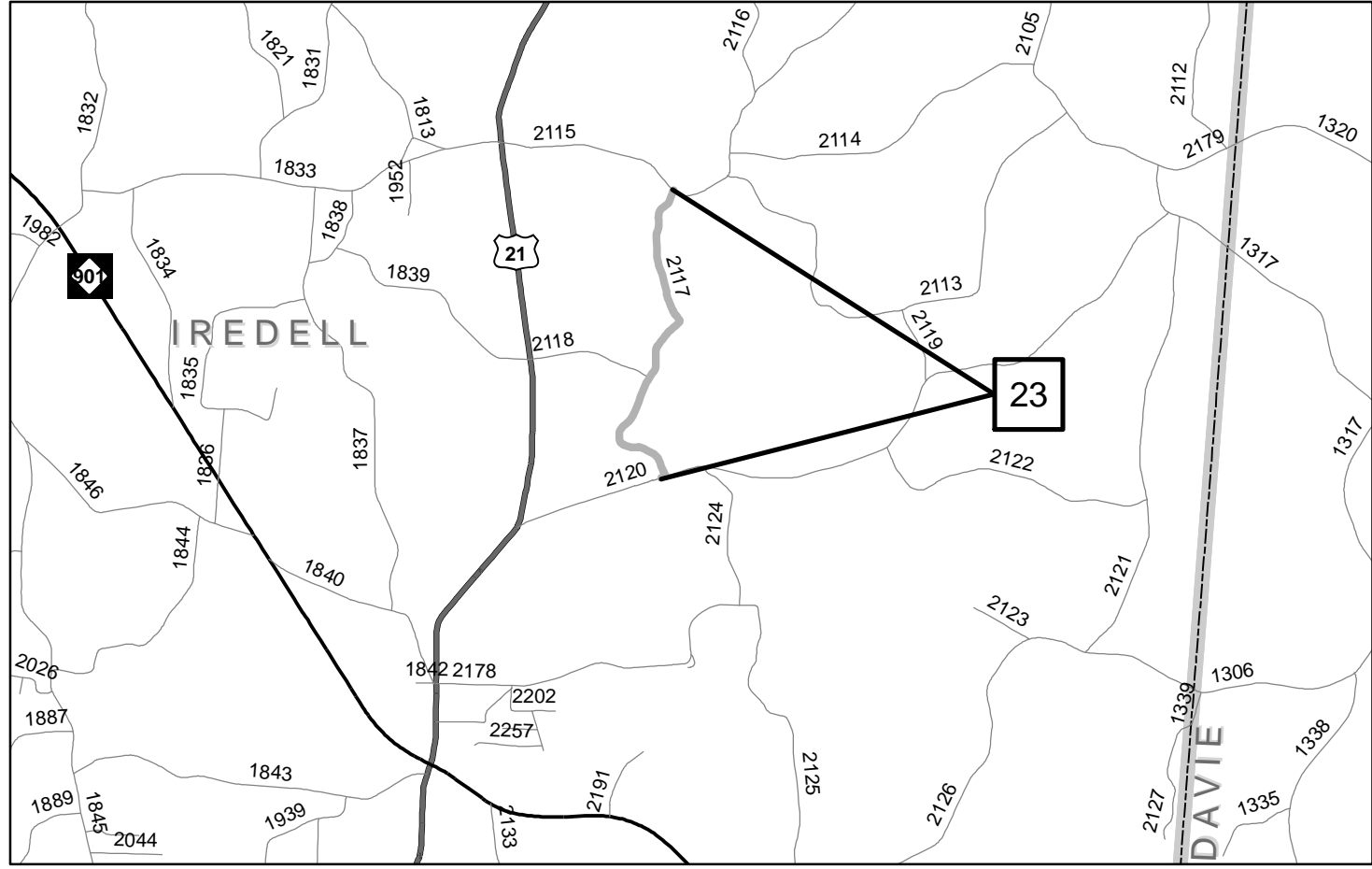
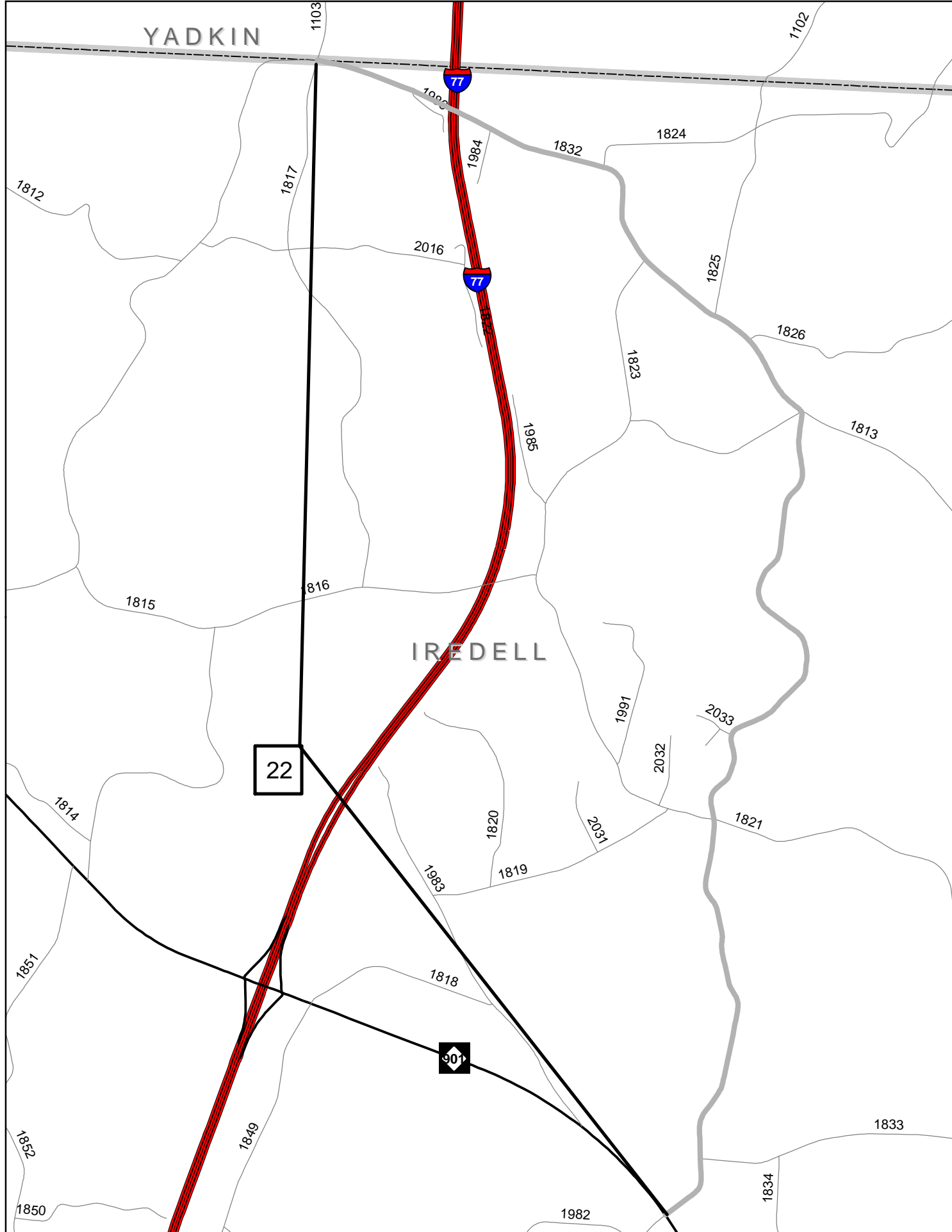

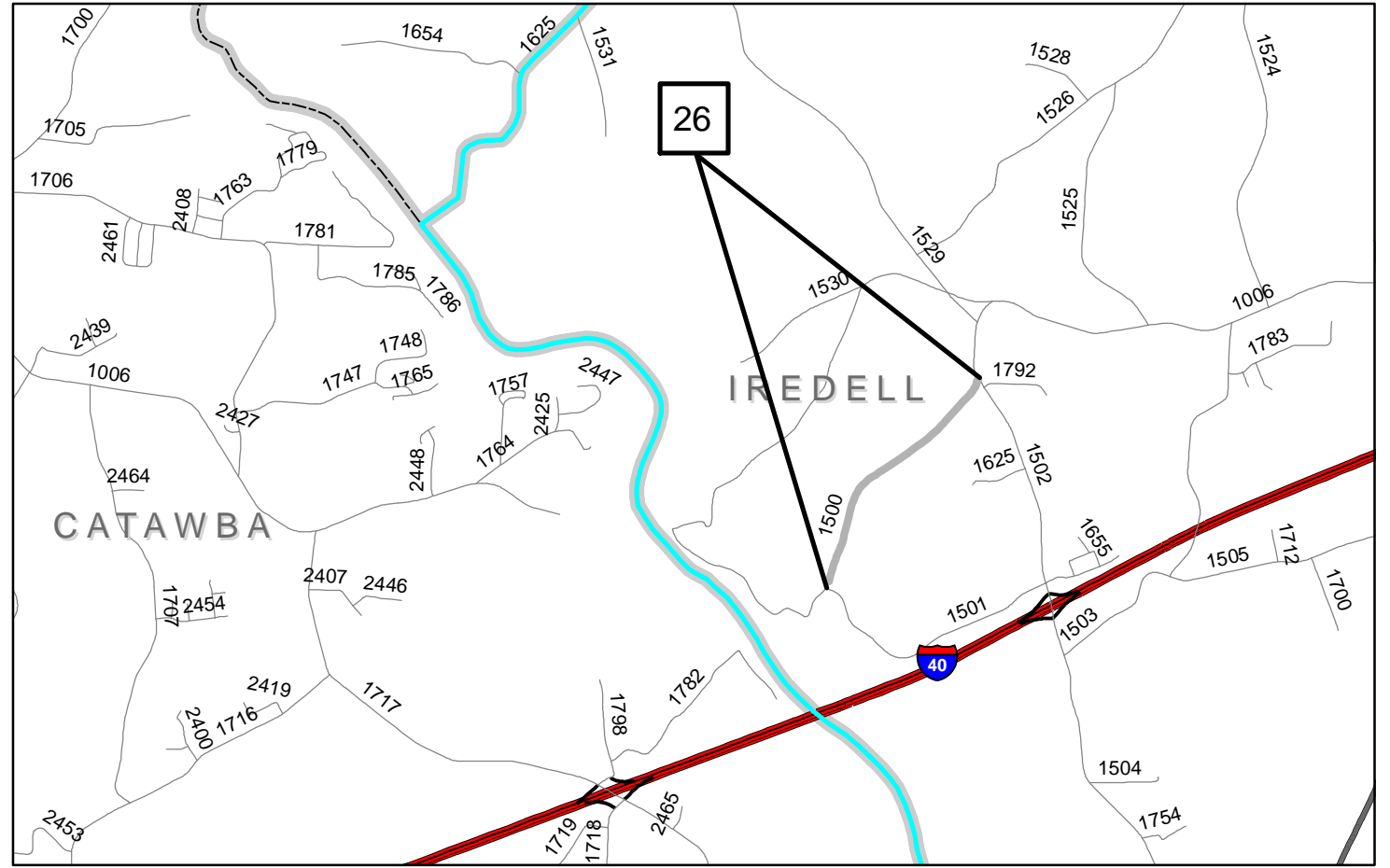
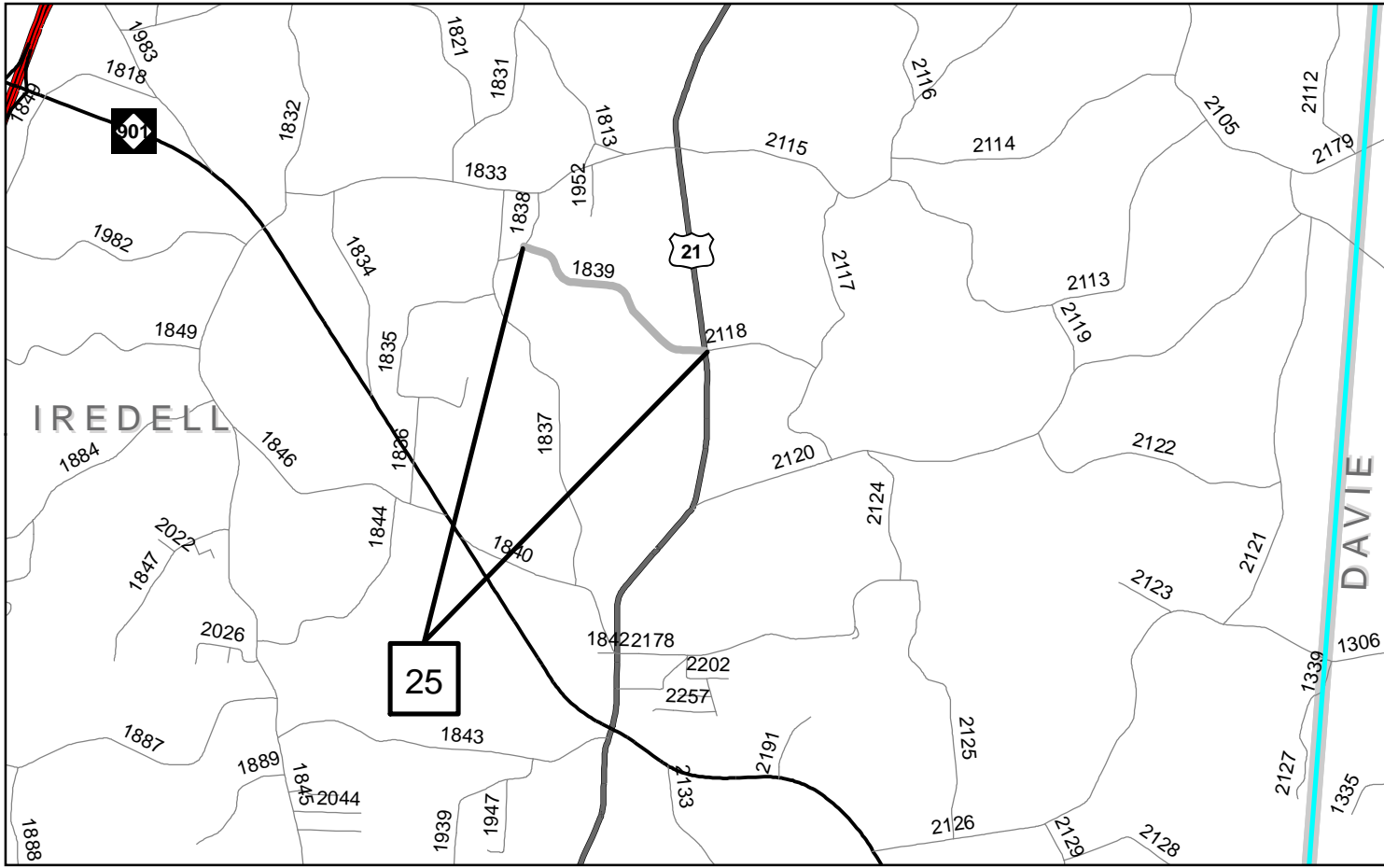



PAVEMENT SCHEDULE

STATE	PROJECT WBS	SHEET NUMBER
NC	2021CPT.12.01.20022	9
	2021CPT.12.01.20492	

F	ASPHALT SURFACE TREATMENT, DOUBLE SEAL, USING A TOP LIFT OF LIGHTWEIGHT AGGREGATE AND A BOTTOM LIFT OF 78M AGGREGATE.
G	ASPHALT SURFACE TREATMENT, FOG SEAL, WITH A TARGET APPLICATION RATE OF 0.12 GAL/SY, +/- 0.03 GAL/SY.

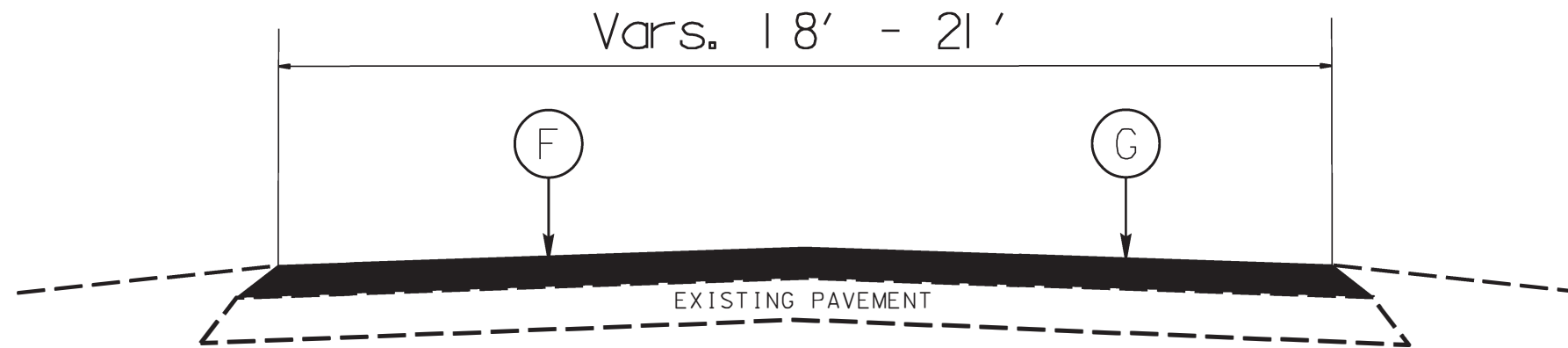

TYPICAL SECTION NO. 1

Checked by:

Drawn by: J.Barneffe

Typical Section  
Alexander & Iredell Co.  
2021-2022 Pvmt. Preservation

PROJECT NO.	SHEET NO.	TOTAL NO.
2021CPT.12.01.20022, 2021CPT.12.01.20492	10	

## SUMMARY OF QUANTITIES

PROJECT NO	COUNTY	MAP NO	ROUTE	DESCRIPTION	TYP NO	LANES	LANE TYPE	FINAL SURFACE TESTING REQUIRED	WARM MIX ASPHALT REQUIRED	LENGTH	WIDTH	1803500000-E	1820000000-E	1838000000-E	2143000000-E		
												ASPHALT SURFACE TREATMENT, DOUBLE SEAL	ASPHALT SURFACE TREATMENT, FOG SEAL	EMULSION FOR ASPHALT SURFACE TREATMENT	BLOTTING SAND		
												MI	FT	SY	SY	GAL	TON
2021CPT.12.01.20022	Alexander	1	SR 1334 (MT. OLIVE CHURCH RD.)	FROM SR 1331 (LITTLE RIVER CHURCH RD.) TO SR 1335 (RUSSELL GAP RD.)	1	2		NO	NO	2.88	18	34,975	34,975	18,187	10		
2021CPT.12.01.20022	Alexander	2	SR 1429 (PLEASANT HILL CHURCH RD.)	FROM SR 1423 (OLD VASHTI RD.) TO SR 1412 (BLACK OAK RIDGE RD.)	1	2		NO	NO	2.01	20	27,122	27,122	14,103	20		
2021CPT.12.01.20022	Alexander	3	SR 1303 (HIDDEN VALLEY RD.)	FROM SR 1304 (MTN. RIDGE RD.) TO DEAD END	1	2		NO	NO	2.33	20	31,439	31,439	16,349	20		
2021CPT.12.01.20022	Alexander	4	SR 1347 (GUS PENNELL RD.)	FROM SR 1303 (HIDDEN VALLEY RD.) TO DEAD END	1	2		NO	NO	0.48	20	6,477	6,477	3,368	10		
2021CPT.12.01.20022	Alexander	5	SR 1310 (ROBINETTE RD.)	FROM SR 1334 (MT. OLIVE CHURCH RD.) TO END OF PVMT.	1	2		NO	NO	1.66	18	20,159	20,159	10,483	20		
2021CPT.12.01.20022	Alexander	6	SR 1313 (THREE FORKS CHURCH RD.)	FROM NC 90 TO SR 1311 (GILL CHILDRESS RD.)	1	2		NO	NO	5.95	18	72,257	72,257	37,574	60		
2021CPT.12.01.20022	Alexander	7	SR 1307 (ALL HEALING SPRINGS RD.)	FROM SR 1313 (THREE FORKS CHURCH RD.) TO SR 1310 (ROBINETTE RD.)	1	2		NO	NO	3.55	18	43,111	43,111	22,418	40		
2021CPT.12.01.20022	Alexander	8	SR 1412 (BLACK OAK RIDGE RD.)	FROM SR 1404 (DANIELS LUMBER RD.) TO SR 1403 (VASHTI RD.)	1	2		NO	NO	3.51	20	47,362	47,362	24,628	40		
<b>TOTAL FOR PROJ NO. 2021CPT.12.01.20022</b>												<b>22.37</b>		<b>282,902</b>	<b>282,902</b>	<b>147,110</b>	<b>220</b>
2021CPT.12.01.20492	Iredell	9	SR 1590 (BROOKHAVEN RD.)	FROM ALEX. COUNTY LINE TO NC 115	1	2		NO	NO	3.77	18	45,783	45,783	23,807	40		
2021CPT.12.01.20492	Iredell	10	SR 1526 (NEW STERLING RD.)	FROM SR 1005 (OLD MTN. RD.) TO SR 1529 (SHARON SCHOOL RD.)	1	2		NO	NO	3.01	18	36,553	36,553	19,008	30		
2021CPT.12.01.20492	Iredell	11	SR 1583 (MOUNTAIN VIEW RD.)	FROM NC 115 TO SR 1614 (MOUNTAIN VIEW RD.)	1	2		NO	NO	1.7	20	22,939	22,939	11,928	20		
2021CPT.12.01.20492	Iredell	12	SR 1524 (POPE FARM RD.)	FROM SR 1006 (ISLAND FORD RD.) TO SR 1526 (NEW STERLING RD.)	1	2		NO	NO	1.94	20	26,177	26,177	13,612	20		
2021CPT.12.01.20492	Iredell	13	SR 1828 (BARNARD MILL RD.)	FROM US 21 TO END PVMT.	1	2		NO	NO	1.32	18	16,030	16,030	8,336	10		
2021CPT.12.01.20492	Iredell	14	SR 1579 (JOHNSON FARM RD.)	FROM ALEXANDER COUNTY LINE TO SR 1577 (PISGAH RIDGE CIRCLE)	1	2		NO	NO	1.13	20	15,247	15,247	7,929	10		
2021CPT.12.01.20492	Iredell	15	SR 1860 (GOFORTH RD.)	FROM SR 1862 (MEYERS MILL RD.) TO SR 1861 (TRUMPET BRANCH RD.)	1	2		NO	NO	1.16	18	14,087	14,087	7,325	10		
2021CPT.12.01.20492	Iredell	16	SR 1904 (FORD FARM RD.)	FROM SR 1572 (HILL DAIRY RD.) TO SR 1903 (SNOW CREEK RD.)	1	2		NO	NO	1.01	20	13,628	13,628	7,087	10		
2021CPT.12.01.20492	Iredell	17	SR 1607 (SANDBURG RD.)	FROM SR 1598 (LINNEYS MILL RD.) TO NC 115	1	2		NO	NO	2.35	20	31,709	31,709	16,489	20		
2021CPT.12.01.20492	Iredell	18	SR 1880 (MT. VERNON CHURCH RD.)	FROM SR 1892 (JENNINGS RD.) TO SR 1896 (FRIENDSHIP RD.)	1	2		NO	NO	2.33	20	31,439	31,439	16,349	20		
2021CPT.12.01.20492	Iredell	19	SR 1908 (BRANCHWOOD RD.)	FROM SR 1907 (S. CHIPLEY FORD RD.) TO END PVMT.	1	2		NO	NO	0.37	18	4,493	4,493	2,337	10		
2021CPT.12.01.20492	Iredell	20	SR 2129 (DYSON RD.)	FROM NC 90 TO SR 2126 (SHEFIELD RD.)	1	2		NO	NO	0.97	18	11,780	11,780	6,125	10		
2021CPT.12.01.20492	Iredell	21	SR 1598 (LINNEYS MILL RD.)	FROM ALEXANDER COUNTY LINE TO NC 115	1	2		NO	NO	4.31	18	52,341	52,341	27,217	40		
2021CPT.12.01.20492	Iredell	22	SR 1832 (EAGLE MILL RD./UNION GROVE RD.)	FROM SR 1817 (ZION LIBERTY RD.) TO NC 901	1	2		NO	NO	5.45	20	73,539	73,539	38,240	50		
2021CPT.12.01.20492	Iredell	23	SR 2117 (KENNESAW RD.)	FROM SR 2115 (E. HOUSTONVILLE RD.) TO SR 2120 (POWELL BRIDGE RD.)	1	2		NO	NO	1.83	20	24,693	24,693	12,840	20		
2021CPT.12.01.20492	Iredell	24	SR 1582 (DAMASCUS CHURCH RD.)	FROM NC 115 TO DEAD END	1	2		NO	NO	0.68	18	8,258	8,258	4,294	10		
2021CPT.12.01.20492	Iredell	25	SR 1839 (COUNTRYSIDE RD.)	FROM SR 1838 (IVYDALE RD.) TO US 21	1	2		NO	NO	1.28	20	17,271	17,271	8,981	10		
2021CPT.12.01.20492	Iredell	26	SR 1500 (LOOKOUT DAMN RD.)	FROM SR 1501 (WALNUT TREE RD.) TO SR 1502 (SHARON SCHOOL RD.)	1	2		NO	NO	1.29	18	15,666	15,666	8,146	10		
<b>TOTAL FOR PROJ NO. 2021CPT.12.01.20492</b>												<b>35.9</b>		<b>461,633</b>	<b>461,633</b>	<b>240,050</b>	<b>350</b>
<b>GRAND TOTAL</b>												<b>58.27</b>		<b>744,535</b>	<b>744,535</b>	<b>387,160</b>	<b>570</b>

PROJECT NO.	SHEET NO.	TOTAL NO.
2021CPT.12.01.20022, 2021CPT.12.01.20492	11	

**THERMOPLASTIC AND PAINT QUANTITIES**

PROJECT NO	COUNTY	MAP NO	ROUTE	DESCRIPTION	TYP NO	LANES	LANE TYPE	LENGTH		WIDTH	4400000000-E	4457000000-N	4810000000-E	4810000000-E
								MI	FT		WORK ZONE ADVANCE/GENERAL WARNING SIGNING	TEMPORARY TRAFFIC CONTROL	4" WHITE PAINT	4" YELLOW PAINT
								SF	LS	LF	LF			
2021CPT.12.01.20022	Alexander	1	SR 1334 (MT. OLIVE CHURCH RD.)	FROM SR 1331 (LITTLE RIVER CHURCH RD.) TO SR 1335 (RUSSELL GAP RD.)	1	2		2.88	18		325	*	62,000	62,000
2021CPT.12.01.20022	Alexander	2	SR 1429 (PLEASANT HILL CHURCH RD.)	FROM SR 1423 (OLD VASHTI RD.) TO SR 1412 (BLACK OAK RIDGE RD.)	1	2		2.01	20		225	*	43,255	43,255
2021CPT.12.01.20022	Alexander	3	SR 1303 (HIDDEN VALLEY RD.)	FROM SR 1304 (MTN. RIDGE RD.) TO DEAD END	1	2		2.33	20		260	*	50,142	50,142
2021CPT.12.01.20022	Alexander	4	SR 1347 (GUS PENNELL RD.)	FROM SR 1303 (HIDDEN VALLEY RD.) TO DEAD END	1	2		0.48	20		55	*	10,330	10,330
2021CPT.12.01.20022	Alexander	5	SR 1310 (ROBINETTE RD.)	FROM SR 1334 (MT. OLIVE CHURCH RD.) TO END OF PVMT.	1	2		1.66	18		185	*	35,725	35,725
2021CPT.12.01.20022	Alexander	6	SR 1313 (THREE FORKS CHURCH RD.)	FROM NC 90 TO SR 1311 (GILL CHILDRESS RD.)	1	2		5.95	18		670	*	128,044	128,044
2021CPT.12.01.20022	Alexander	7	SR 1307 (ALL HEALING SPRINGS RD.)	FROM SR 1313 (THREE FORKS CHURCH RD.) TO SR 1310 (ROBINETTE RD.)	1	2		3.55	18		400	*	76,396	76,396
2021CPT.12.01.20022	Alexander	8	SR 1412 (BLACK OAK RIDGE RD.)	FROM SR 1404 (DANIELS LUMBER RD.) TO SR 1403 (VASHTI RD.)	1	2		3.51	20		400	*	75,535	75,535
<b>TOTAL FOR PROJ NO. 2021CPT.12.01.20022</b>								<b>22.37</b>			<b>2,520</b>	<b>*</b>	<b>481,427</b>	<b>481,427</b>
2021CPT.12.01.20492	Iredell	9	SR 1590 (BROOKHAVEN RD.)	FROM ALEX. COUNTY LINE TO NC 115	1	2		3.77	18		425	*	81,130	81,130
2021CPT.12.01.20492	Iredell	10	SR 1526 (NEW STERLING RD.)	FROM SR 1005 (OLD MTN. RD.) TO SR 1529 (SHARON SCHOOL RD.)	1	2		3.01	18		335	*	64,775	64,775
2021CPT.12.01.20492	Iredell	11	SR 1583 (MOUNTAIN VIEW RD.)	FROM NC 115 TO SR 1614 (MOUNTAIN VIEW RD.)	1	2		1.7	20		190	*	36,584	36,584
2021CPT.12.01.20492	Iredell	12	SR 1524 (POPE FARM RD.)	FROM SR 1006 (ISLAND FORD RD.) TO SR 1526 (NEW STERLING RD.)	1	2		1.94	20		220	*	41,749	41,749
2021CPT.12.01.20492	Iredell	13	SR 1828 (BARNARD MILL RD.)	FROM US 21 TO END PVMT.	1	2		1.32	18		150	*	28,406	28,406
2021CPT.12.01.20492	Iredell	14	SR 1579 (JOHNSON FARM RD.)	FROM ALEXANDER COUNTY LINE TO SR 1577 (PISGAH RIDGE CIRCLE)	1	2		1.13	20		130	*	24,318	24,318
2021CPT.12.01.20492	Iredell	15	SR 1860 (GOFORTH RD.)	FROM SR 1862 (MEYERS MILL RD.) TO SR 1861 (TRUMPET BRANCH RD.)	1	2		1.16	18		130	*	24,963	24,963
2021CPT.12.01.20492	Iredell	16	SR 1904 (FORD FARM RD.)	FROM SR 1572 (HILL DAIRY RD.) TO SR 1903 (SNOW CREEK RD.)	1	2		1.01	20		115	*	21,735	21,735
2021CPT.12.01.20492	Iredell	17	SR 1607 (SANDBURG RD.)	FROM SR 1598 (LINNEYS MILL RD.) TO NC 115	1	2		2.35	20		265	*	50,572	50,572
2021CPT.12.01.20492	Iredell	18	SR 1880 (MT. VERNON CHURCH RD.)	FROM SR 1892 (JENNINGS RD.) TO SR 1896 (FRIENDSHIP RD.)	1	2		2.33	20		265	*	50,142	50,142
2021CPT.12.01.20492	Iredell	19	SR 1908 (BRANCHWOOD RD.)	FROM SR 1907 (S. CHIPLEY FORD RD.) TO END PVMT.	1	2		0.37	18		45	*	7,962	7,962
2021CPT.12.01.20492	Iredell	20	SR 2129 (DYSON RD.)	FROM NC 90 TO SR 2126 (SHEFIELD RD.)	1	2		0.97	18		110	*	20,874	20,874
2021CPT.12.01.20492	Iredell	21	SR 1598 (LINNEYS MILL RD.)	FROM ALEXANDER COUNTY LINE TO NC 115	1	2		4.31	18		485	*	92,751	92,751
2021CPT.12.01.20492	Iredell	22	SR 1832 (EAGLE MILL RD./UNION GROVE RD.)	FROM SR 1817 (ZION LIBERTY RD.) TO NC 901	1	2		5.45	20		610	*	117,284	117,284
2021CPT.12.01.20492	Iredell	23	SR 2117 (KENNESAW RD.)	FROM SR 2115 (E. HOUSTONVILLE RD.) TO SR 2120 (POWELL BRIDGE RD.)	1	2		1.83	20		205	*	39,382	39,382
2021CPT.12.01.20492	Iredell	24	SR 1582 (DAMASCUS CHURCH RD.)	FROM NC 115 TO DEAD END	1	2		0.68	18		80	*	14,634	14,634
2021CPT.12.01.20492	Iredell	25	SR 1839 (COUNTRYSIDE RD.)	FROM SR 1838 (IVYDALE RD.) TO US 21	1	2		1.28	20		145	*	27,546	27,546
2021CPT.12.01.20492	Iredell	26	SR 1500 (LOOKOUT DAMN RD.)	FROM SR 1501 (WALNUT TREE RD.) TO SR 1502 (SHARON SCHOOL RD.)	1	2		1.29	18		145	*	27,761	27,761
<b>TOTAL FOR PROJ NO. 2021CPT.12.01.20492</b>								<b>35.9</b>			<b>4,050</b>	<b>*</b>	<b>772,568</b>	<b>772,568</b>
<b>GRAND TOTAL</b>								<b>58.27</b>			<b>6,570</b>	<b>1</b>	<b>1,253,995</b>	<b>1,253,995</b>

## SIGNING FOR ASPHALT SURFACE TREATMENT

**LEGEND**

- ◻ PORTABLE SIGN
- └ STATIONARY SIGN
- ← DIRECTION OF TRAFFIC FLOW

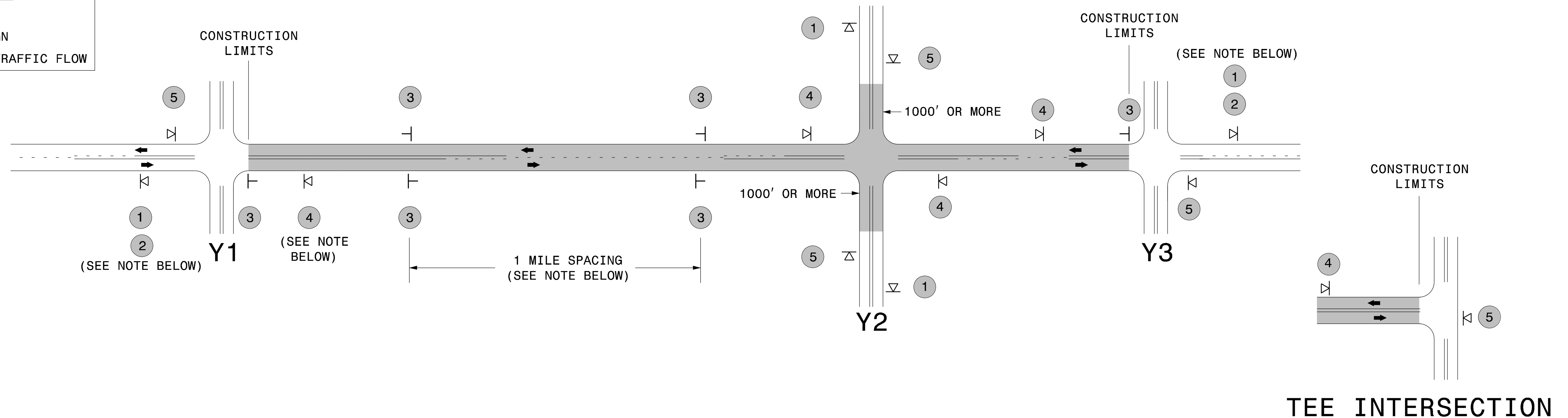

### MAINLINE (-L-) SIGNING

### -Y- LINE SIGNING

<b>SIGNING NOTES AND PLACEMENT PER DIRECTION</b>	1	 	<ul style="list-style-type: none"> <li>- PLACE 1000' PRIOR TO BEGINNING OF CONSTRUCTION LIMITS. ONLY USED ON -Y- LINES IF RESURFACING LIMITS EXTEND 1000' ALONG -Y- LINE.</li> <li>- SIGN #2 ONLY USED WHEN RESURFACING LIMITS ARE 2 OR MORE MILES IN LENGTH. ROUND UP TO THE NEAREST WHOLE NUMBER. DO NOT USE FRACTIONAL OR DECIMAL NUMBERS.</li> </ul>	<p><b>STATIONARY SIGNING NOT REQUIRED FOR THE FOLLOWING -Y- LINE CONDITIONS:</b></p> <ol style="list-style-type: none"> <li>1) LESS THAN 1000' OF RESURFACING ALONG -Y- LINE</li> <li>2) SUBDIVISION ROADS</li> <li>3) DEAD END ROADS</li> </ol> <p>WHEN PAVING/CONSTRUCTION ACTIVITIES PROCEED ACROSS AN UNSIGNED -Y- LINE, PORTABLE ADVANCE WARNING SIGNS SHALL BE USED ALONG THE -Y- LINE AS SHOWN BELOW. REMOVE UPON COMPLETION OF WORK.</p> <div style="display: flex; justify-content: space-around; align-items: center;"> <div style="text-align: center;">   <small>W20-1 48" X 48"</small>              PLACED 500' IN ADVANCE OF FLAGGER.         </div> <div style="text-align: center;">   <small>W20-7 A 48" X 48"</small>              PLACED 250' IN ADVANCE OF FLAGGER.         </div> </div>
	3	 	<ul style="list-style-type: none"> <li>- ALTERNATE THE FOLLOWING TWO SIGNS:</li> <li>- STARTING WITH "LOOSE GRAVEL" (W8-7) FOLLOWED BY "UNMARKED PAVEMENT".</li> <li>- PLACE INITIALLY AT THE CONSTRUCTION LIMITS AND SPACED 1 MILE APART THEREAFTER.</li> <li>- AT TEE INTERSECTIONS INSTALL INITIALLY 0.5 MILE FROM INTERSECTION AND SPACE 1 MILE APART THEREAFTER.</li> </ul>	
	4		<ul style="list-style-type: none"> <li>- THESE ARE FOR -Y- LINES THAT ARE "THROUGH" ROADWAYS. DEAD END AND SUBDIVISION ROADS ARE NOT "THROUGH" ROADWAYS.</li> <li>- INSTALL 500' +/- FROM EACH -Y- LINE APPROACH AS SHOWN ABOVE.</li> <li>- FOR MULTIPLE -Y- LINES THAT ARE SEPARATED BY 0.25 MILES OR LESS, TREAT AS A SINGLE UNIT AND INSTALL WITHIN 500' OF EACH APPROACH.</li> <li>- A MAXIMUM OF 2 SIGN SETS PER MILE. DO NOT INSTALL WHEN -Y- LINES ARE WITHIN 0.5 MILES FROM "END ROAD WORK" SIGN.</li> </ul>	
	5		<ul style="list-style-type: none"> <li>- PLACE 500' FOLLOWING THE END OF CONSTRUCTION LIMITS OR AS SHOWN WHEN WORK ENDS AT A 3-WAY TEE INTERSECTION.</li> </ul>	
	<p>THE ABOVE SIGNS ARE ALL THAT ARE REQUIRED FOR A CONTRACTOR TO BEGIN A RESURFACING CONTRACT. ANY ADDITIONAL SIGNS REQUESTED BY NCDOT DIVISIONS SHALL BE INSTALLED WITHIN 7 BUSINESS DAYS OF THE START OF CONTRACT WORK.</p>			

**MAPS LESS THAN 2 MILES**

FOR AST RESURFACING MAPS WITH CONSTRUCTION LIMITS LESS THAN 2 MILES IN LENGTH, USE A STATIONARY "LOOSE GRAVEL" SIGN AT THE BEGINNING CONSTRUCTION LIMIT FOLLOWED BY AN "UNMARKED PAVEMENT" SIGN MIDWAY THROUGH AND AN "END ROAD WORK" SIGN AT THE END CONSTRUCTION LIMIT.

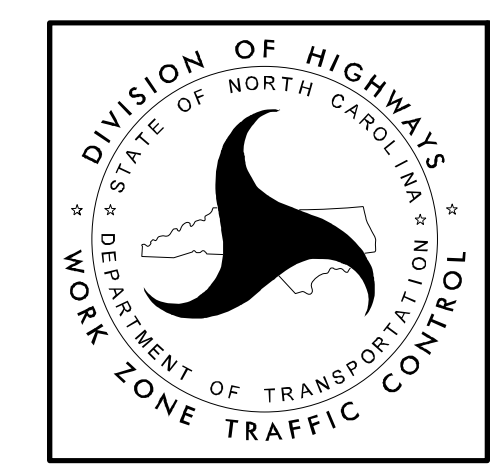

**ADVANCE WARNING SIGNS FOR 2-LANE ROADWAY ASPHALT SURFACE TREATMENT**

5/12/2017 S:\TUXWZTC\Resurfacing\2L2W & AST Resurfacing Details\Resurfacing\_AdvWarn\_2Ln - AST.dgn User:kadais